

MEASURING TOOL, GAGING, AND FIXTURING ACCESSORIES

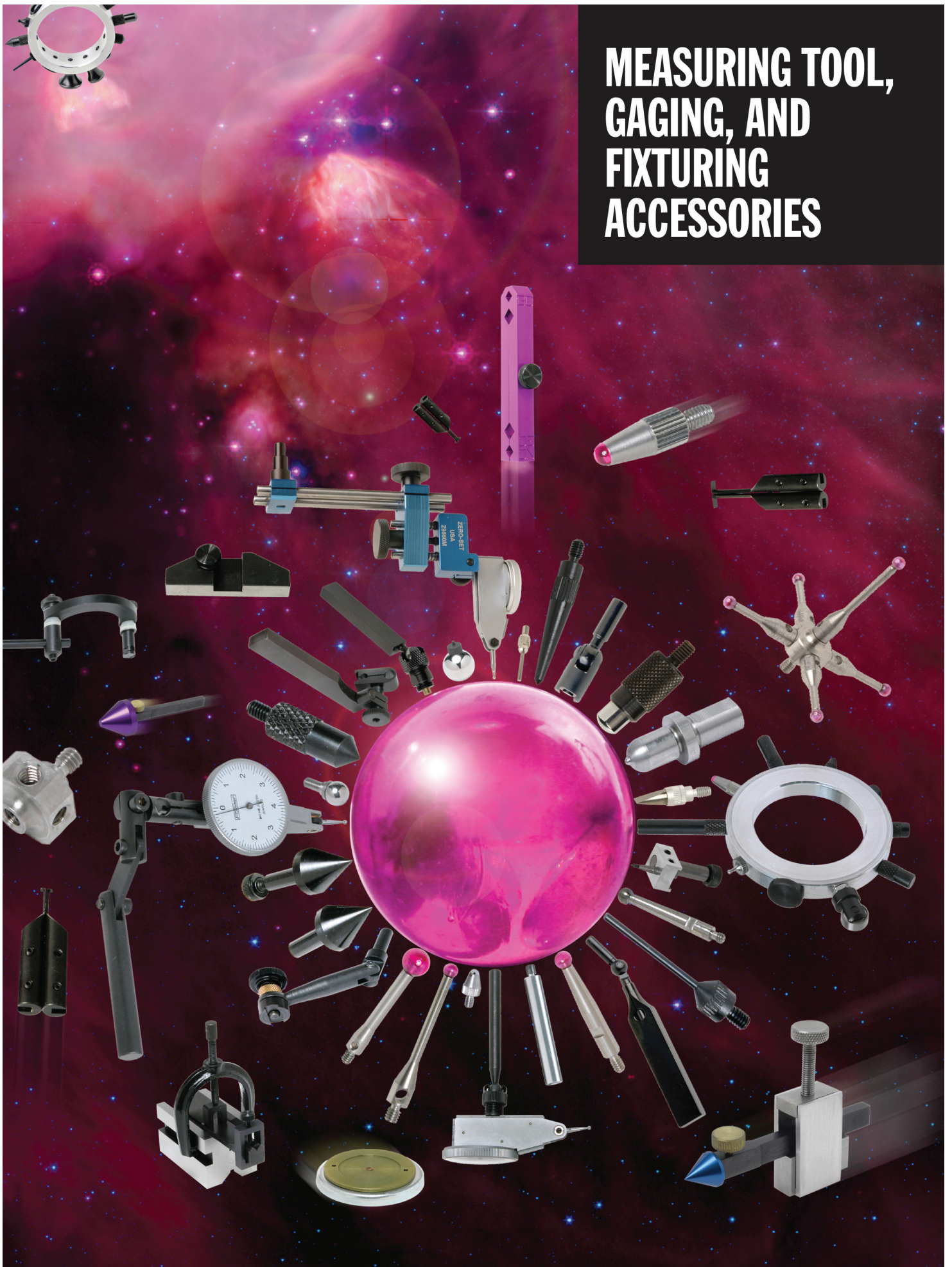



AGD Drop Dial Indicator Points

USA **MADE**

Dial Indicator Points

Our wide range of styles and sizes of contact points fit all AGD 1,2,3,4 series Dial Indicators **with 4-48 threads**.
All items Made In USA.

Please call us for special and custom sizes and designs, as we can manufacture to your print or specifications.
We are constantly adding new contacts, and can cross reference from most other manufacturers part numbers.

Material: Corrosion Resistant 303 Stainless Steel

AGD Drop Dial Indicator Points

Type	Body Diameter	Length	Order Number
Flat	7/32"	1/8"	Z9307SS
Flat	5/16	.175	Z9309SS
Flat	7/32	.175	Z9310SS
Flat	7/32	1/4	Z9311SS
Flat	7/32	3/8	Z9312SS
Flat	7/32	1/2	Z9313SS
Flat	7/32	5/8	Z9314SS
Flat	7/32	3/4	Z9315SS
Flat	7/32	7/8	Z9316SS
Flat	7/32	.895	Z9317SS
Flat	7/32	1	Z9308SS
Flat	7/32	1-1/4	Z9318SS
Flat	7/32	1-1/2	Z9319SS
Flat	7/32	1-3/4	Z9358SS
Flat	7/32	2	Z9359SS
Ball	7/32	7/32	Z9320SS
Ball	7/32	13/32	Z9321SS
Ball	7/32	5/8	Z9322SS
Ball	7/32	13/16	Z9324SS
Ball	7/32	7/8	Z9323SS
Ball	3/16	1	Z9325SS
Cone	7/32	1/2	Z9332SS
Cone	7/32	5/8	Z9329SS
Cone	7/32	3/4	Z9328SS
Cone	7/32	7/8	Z9327SS
Cone	7/32	1	Z9361SS
Cone	7/32	1-1/4	Z9362SS

Flat Point

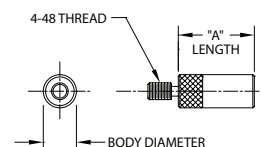

Ball Point

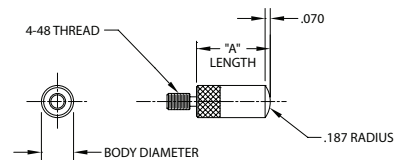

Cone Point

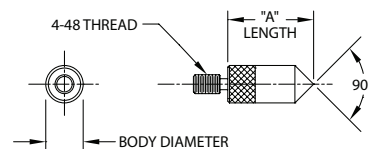

(Cone points have 90 degree angle.
Length does not include threads.)

Flat Point

Ball Point

Cone Point

**SPECIAL ORDERS
AVAILABLE—
Small Quantities
to Large Volume**



USA **MADE**



AGD Drop Dial Indicator Points

USA  **MADE**

Stem Indicator Points

Specially designed for user modifications. These single and double stem indicator points can be shaped for your special application. The reduced diameter stem can be angled and positioned for hard to reach areas. Please note that these points can vary, and dimensions are approximate.

- AGD Standard 4-48 Threads
- Type 303 Stainless Steel
- Corrosion Resistant
- Made in USA

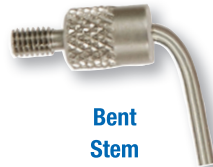

**Bent
Stem**

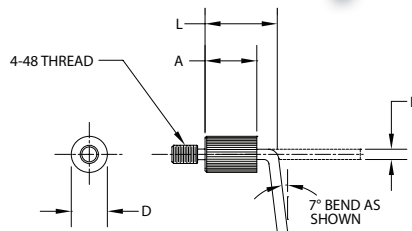

**NOW AVAILABLE
IN METRIC M2.5
THREADS**

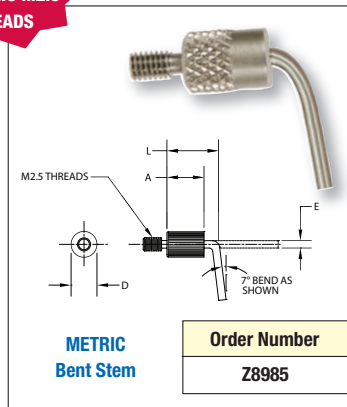

**METRIC
Bent Stem**

Order Number

Z8985



Double Stem

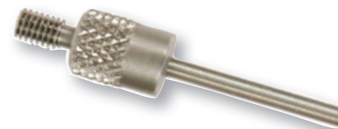
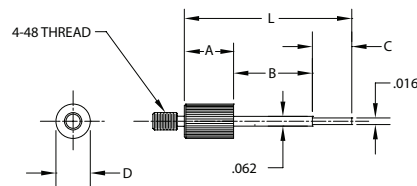

Single Stem

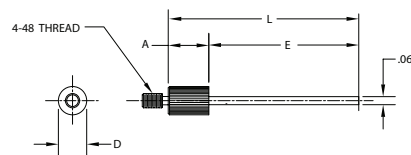

Stem Indicator Points							
Type	D	A	E	L	C	B	Order Number
Bent Stem	7/32"	5/16"	1/16"	7/16"	n/a	n/a	Z9333SS
Double Stem	7/32	5/16	n/a	45/64	1/8	1/4	Z9334SS
Double Stem	7/32	1/4	n/a	31/32	3/32	19/32	Z9336SS
Double Stem	7/32	1/4	n/a	31/32	15/64	15/32	Z9337SS
Double Stem	3/16	5/16	n/a	3/4	7/64	19/64	Z9349SS
Single Stem	3/16	3/16	1/16 Dia x 1-5/32 Lth	1-23/64	n/a	n/a	Z9338LSS
Single Stem	7/32	3/16	1/16 Dia x 3/4 Lth	15/16	n/a	n/a	FOW-52-525-112

USA  **MADE**

Accurate
Manufactured
Products
Group

Phone: 317-472-9000 • FAX: 317-472-9010 • email: sales@ampg.com • www.ampg.com





AGD Drop Dial Indicator Point Kits

USA **MADE**



Select-A-Point Kit

22 pieces of the most popular indicator points, including flat, ball, cone, and stems.

Fits all AGD 1,2,3 and 4 style drop indicators.

All Points have 4-48 thread and are made from **corrosion resistant Type 303 Stainless Steel**.

Made in USA

KIT INCLUDES:

- (1) Z9310SS—Flat Point 7/32" Dia X 1 1/64" Lth
- (1) Z9311SS—Flat Point 7/32" Dia X 1/4" Lth
- (1) Z9312SS—Flat Point 7/32" Dia X 3/8" Lth
- (1) Z9313SS—Flat Point 7/32" Dia X 1/2" Lth
- (1) Z9314SS—Flat Point 7/32" Dia X 5/8" Lth
- (1) Z9315SS—Flat Point 7/32" Dia X 3/4" Lth
- (1) Z9316SS—Flat Point 7/32" Dia X 7/8" Lth
- (1) Z9317SS—Flat Point 7/32" Dia X 57/64" Lth
- (1) Z9318SS—Flat Point 7/32" Dia X 1-1/4" Lth
- (1) Z9320SS—Ball Point 7/32" Dia X 7/32" Lth
- (1) Z9321SS—Ball Point 7/32" Dia X 25/64" Lth
- (1) Z9322SS—Ball Point 7/32" Dia X 5/8" Lth
- (1) Z9323SS—Ball Point 7/32" Dia X 7/8" Lth
- (1) Z9324SS—Ball Point 7/32" Dia X 53/64" Lth
- (1) Z9327SS—Cone Point 7/32" Dia X 7/8" Lth
- (1) Z9328SS—Cone Point 7/32" Dia X 3/4" Lth
- (1) Z9329SS—Cone Point 7/32" Dia X 5/8" Lth
- (1) Z9332SS—Cone Point 7/32" Dia X 1/2" Lth
- (1) Z9333SS—Bent Stem Point 1/16" Dia X 5/16" Lth
- (1) Z9336SS—Double Stem Point 1/16" Dia X 15/16" Lth
- (1) Z9338SS—Stem Point 1/16" Dia X 21/32" Lth
- (1) Z9337SS—Double Stem Point 1/16" Dia X 61/64" Lth

Order Number

Z9000SS

USA **MADE**

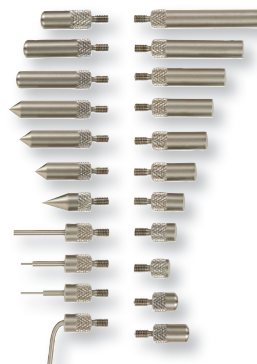

Mini-Point Kit

A smaller version of our Select-A-Point Kit.

This version consists of 11 points.

One stem point and 10 Flat, Ball, and Cone, points.

All Points have 4-48 thread and are made from **corrosion resistant Type 303 Stainless Steel**.

Made in USA

KIT INCLUDES:

- (1) Z9311SS—Flat Point 7/32" Dia X 1/4" Lth
- (1) Z9312SS—Flat Point 7/32" Dia X 3/8" Lth
- (1) Z9313SS—Flat Point 7/32" Dia X 1/2" Lth
- (1) Z9314SS—Flat Point 7/32" Dia X 5/8" Lth
- (1) Z9316SS—Flat Point 7/32" Dia X 7/8" Lth
- (1) Z9318SS—Flat Point 7/32" Dia X 1-1/4" Lth
- (1) Z9320SS—Ball Point 7/32" Dia X 7/32" Lth
- (1) Z9322SS—Ball Point 7/32" Dia X 5/8" Lth
- (1) Z9329SS—Cone Point 7/32" Dia X 5/8" Lth
- (1) Z9328SS—Cone Point 7/32" Dia X 3/4" Lth
- (1) Z9333SS—Bent Stem 1/16" Dia X 5/16" Lth

Order Number

Z9001

USA **MADE**



**SPECIAL ORDERS
AVAILABLE—
Small Quantities
to Large Volume**





AGD Drop Dial Indicator Points

USA MADE

Ruby Ball Points

Body Material: Corrosion Resistant
303 Stainless Steel

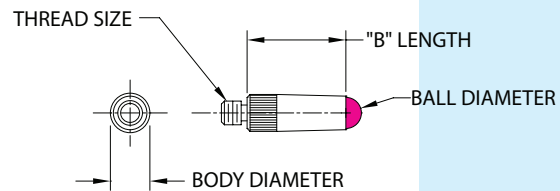

Ruby Ball Point				
Ball Diameter	"B" Length Ball Center to End of Body	Body Diameter	4-48 Threads Order Number	Metric M2.5 Threads Order Number
2mm	.250	.187	Z7025	Z7026
3mm	.250	.187	Z6972	Z6973
4mm	.250	.187	Z6978	Z6979
2mm	.500	.187	Z7027	Z7028
3mm	.500	.187	Z6974	Z7029
4mm	.500	.187	Z6980	Z7030
2mm	.750	.187	Z7031	Z7032
3mm	.750	.187	Z6976	Z7033
4mm	.750	.187	Z6982	Z7034
2mm	1.00	.187	Z7035	Z7036
3mm	1.00	.187	Z7037	Z7038
4mm	1.00	.187	Z7039	Z7040

USA MADE

Flat Carbide Needle Points

Body Material: Corrosion Resistant
303 Stainless Steel

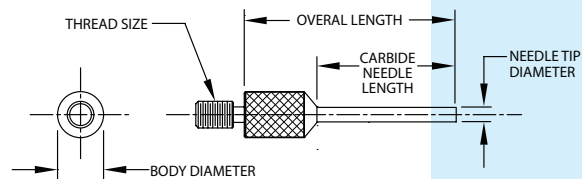
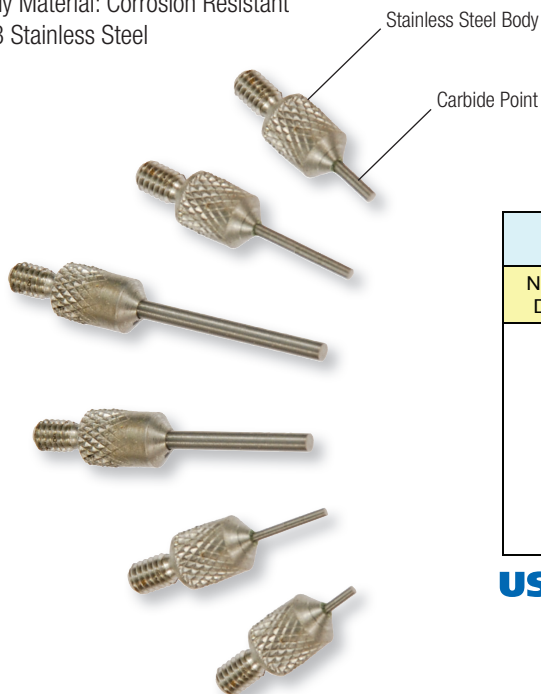

Flat Needle Point — Carbide Tip				
Needle Tip Diameter	Needle Length	Overall Length	Thread	Order Number
.015	.120	.400	4-48	Z7041
.031	.120	.400	4-48	Z7042
.031	.500	.780	4-48	Z7043
.062	.500	.800	4-48	Z7044
.062	1.00	1.300	4-48	Z7045
.078	1.00	1.300	4-48	Z7046
.062	.500	.780	4-48	MT1131279
.062	.500	.780	M2.5	MT1120064
.031	.120	.400	4-48	MT1131280
.031	.120	.400	M2.5	MT1131280M

USA MADE



Accurate
Manufactured
Products
Group

Phone: 317-472-9000 • FAX: 317-472-9010 • email: sales@ampg.com • www.ampg.com



AGD Drop Dial Indicator Points

USA **MADE**

Carbide Ball Points

Body Material: Corrosion Resistant
303 Stainless Steel

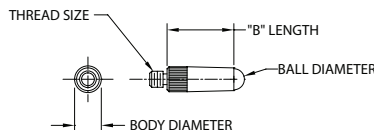

Carbide Ball Point				
Ball Diameter	"B" Length		4-48 Threads	M2.5 Threads
	Ball Center to End of Body	Body Diameter	Order Number	Order Number
2mm	.250	.187	Z6963	Z6965
3mm	.250	.187	Z6960	Z6961
4mm	.250	.187	Z6966	Z6967
3mm	.300	.190	MT1131262	MT1120049
2mm	.500	.187	Z6969	Z6971
3mm	.500	.187	Z6962	Z6975
4mm	.500	.187	Z6968	Z6977
2mm	.750	.187	Z6981	Z7016
3mm	.750	.187	Z6964	Z7017
4mm	.750	.187	Z6970	Z7018
2mm	1.00	.187	Z7019	Z7020
3mm	1.00	.187	Z7021	Z7022
4mm	1.00	.187	Z7023	Z7024

USA **MADE**

Carbide Knife Points

Body Material: Corrosion Resistant
303 Stainless Steel

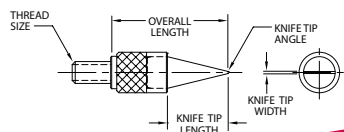

**NOW AVAILABLE
IN METRIC M2.5
THREADS**

Knife Point — Carbide Tip					
Knife Tip Angle	Knife Length	Knife Width	Overall Length	Thread	Order Number
25 Degrees	.300	.160	.600	4-48	MT1131282
25 Degrees	.300	.160	.600	M2.5	MT1120067

USA **MADE**

Carbide Ball Points

Body Material: Corrosion Resistant
303 Stainless Steel

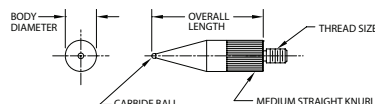

Carbide Ball Points				
Ball Diameter	Body Diameter	Overall Length	Thread	Order Number
.5MM	.25"	.895"	4-40	JL0197RADTIP
1MM	.25	.895	4-40	JL020RADTIP

USA **MADE**

**SPECIAL ORDERS
AVAILABLE—
Small Quantities
to Large Volume**





AGD Drop Dial Indicator Points

USA MADE

Popular Specialized Contacts for Dial Indicators

4-48 threads to fit all AGD Groups 1,2,3,4 Indicators. **Made In USA**

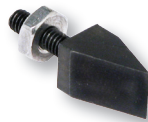
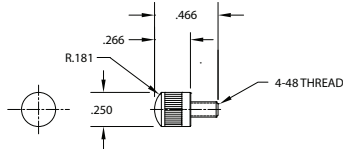
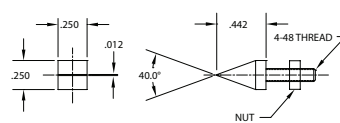
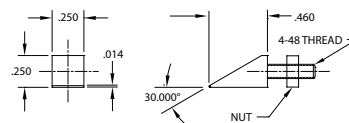
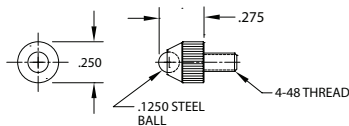
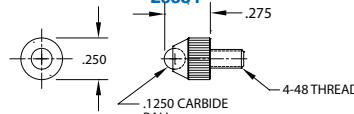
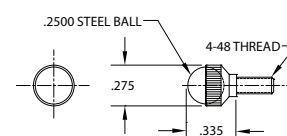
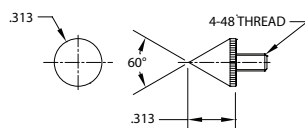
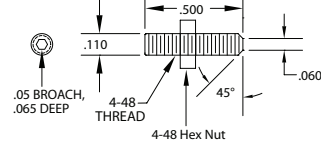
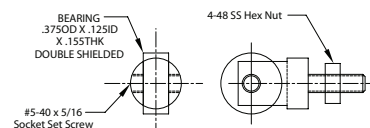
Radius Contact Z9380

Chisel Contact Z9381

Offset Chisel Contact Z9382

1/8" Steel Ball Z9383

1/8" Carbide Ball Z9384

1/4" Steel Ball Z9385

Cone Point Z9386

Needle Stud Z9387

Roller Anvil Z9388

**NOW AVAILABLE
IN METRIC M2.5
THREADS**

Special Dial Indicator Contacts

Contact Type	Description	S-T Industries Functional Equivalent	Order Number
Radius Contact	1/4" Dia. x 17/64" Length	50-5008-00	Z9380
Chisel Contact	.250 tapering to .012" tip, .442 Overall Length	50-5011-00	Z9381
Offset Chisel	.250 tapering to .014" tip, .460 Overall Length	50-5012-00	Z9382
1/8" Steel Ball	1/4" Dia. x .275" Overall Length 1/8" colleted ball	50-5014-00	Z9383
1/8" Carbide Ball	1/4" Dia. x .275" Overall Length 1/8" colleted ball	50-5015-00	Z9384
1/4" Steel Ball	.335 Lth., 4-48 thread	—	Z9385
5/16" Cone Point	5/16" Dia. x 5/16" Length	50-5018-00	Z9386
1/16" Needle Stud	.110" Dia. x .500 Lth., 4-48 thread, .060" Dia. Needle Tip	50-5019-00	Z9387
Roller Anvil	3/8" Roller, 4-48 thread	50-5026-00	Z9388
Roller Anvil	3/8" Roller, M2.5 threads		Z9388M
Cone Point	13/64" Dia., 9/32" Length, 4-48 Thread, Hardened Steel	Starrett PT06632/10	Z9361

USA MADE

Accurate
Manufactured
Products
Group

Phone: 317-472-9000 • FAX: 317-472-9010 • email: sales@ampg.com • www.ampg.com





AGD Drop Dial Indicator Points

USA **MADE**

All-New Specialized Contacts for Dial Indicators

Fit all AGD Groups 1,2,3,4 Indicators. **Made In USA**



**NOW AVAILABLE
IN METRIC M2.5
THREADS**

Flat Contact Z9492

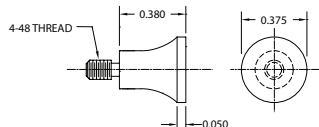

**NOW AVAILABLE
IN METRIC M2.5
THREADS**

Flat Contact Z9491

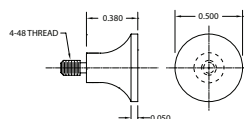

Button Contact Z9356

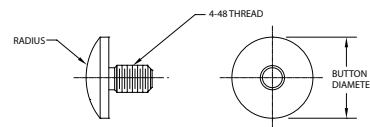

Button Contact Z9355

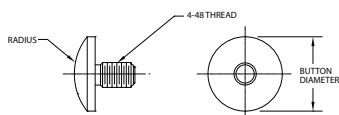

Button Contact Z9496

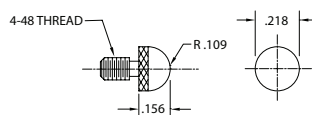

Cone Point Z9332

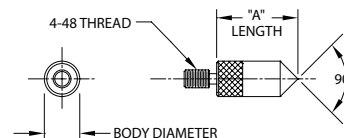

Cone Point Z9361

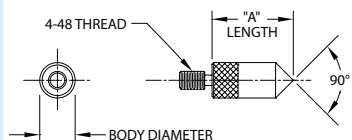

Ball Contact Z9398

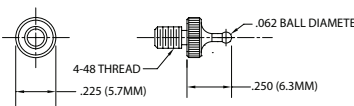

Ball Contact Z9399

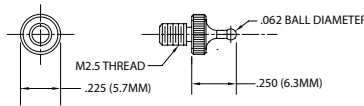

**SPECIAL ORDERS
AVAILABLE—
Small Quantities
to Large Volume**



USA **MADE**

Special Dial Indicator Contacts

Contact Type	Description	Functional Equivalent	Order Number
Flat Contact	3/8 Ground, 3/8" Lth, 4-48 Thds	Starrett PT06632/2 - 70790	Z9492
Flat Contact	3/8 Ground, 3/8" Lth, M2.5 Thds	Starrett PT06632/2 - 70790	Z9492M
Flat Contact	1/2 Ground, 3/8" Lth, 4-48 Thds	Starrett PT06632/3 - 70791	Z9491
Flat Contact	1/2 Ground, 3/8" Lth, M2.5 Thds	Starrett PT06632/3 - 70791	Z9491M
Button Contact	1/2" Button, 4-48 Thds., Steel Black Oxide	Starrett PT06632/4 - 70792	Z9356
Button Contact	3/8" Button, 4-48 Thds., Steel Black Oxide	Starrett PT06632/5 - 70793	Z9355
Button Contact	13/64" Dia X 5/32" Lth, 4-48 Thds., Steel Black Oxide	Starrett #28 - 50199	Z9496
Button Contact	13/64" Dia X 5/32" Lth, M2.5 Thds., Steel Black Oxide	Starrett #28 - 50199	Z9496M
Cone Point	1/2" Lth, 90 Degree, 4-48 Thds., Steel Black Oxide	Starrett PT06632/6 - 70794	Z9332
Cone Point	9/32 Lth, Stl Hard, 4-48 Thds, Black Oxide	Starrett PT06632/10	Z9361
Ball Contact	1/16" Ball, 1/4" Lth, 4-48 Thds., Steel Black Oxide	Starrett PT06632/7 - 70795	Z9398
Ball Contact	1/16" Ball, 1/4" Lth, M2.5 Thds., Steel Black Oxide	Starrett PT06632/7 - 70795	Z9398M
Ball Contact	1/16" Ball, 1/4" Lth, M2.5, Steel Black Oxide	Starrett PT06632/8 - 70796	Z9399





AGD Drop Dial Indicator Points

USA MADE

All-New Specialized Contacts for Dial Indicators

Fit all AGD Groups 1,2,3,4 Indicators. **Made In USA**

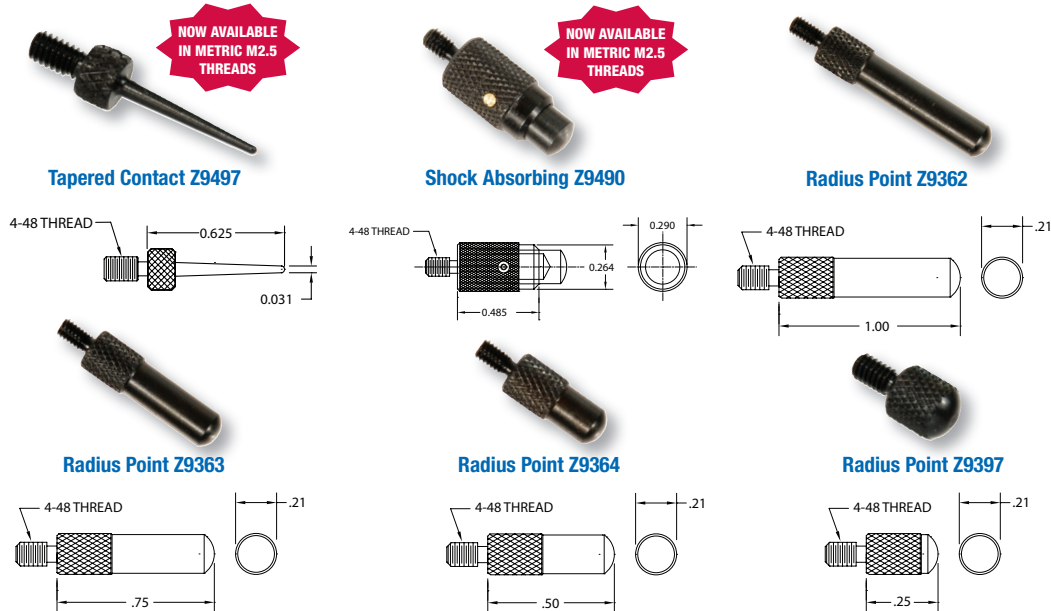

Special Dial Indicator Contacts			
Contact Type	Description	Functional Equivalent	Order Number
Tapered Contact	5/8" Lth, 4-48 Thds., Steel Black Oxide	Starrett PT06632/9 - 70797	Z9497
Tapered Contact	5/8" Lth, M2.5 Thds., Steel Black Oxide	—	Z9497M
Shock Absorbing	4-48 Threads	—	Z9490
Shock Absorbing	M2.5 Threads	—	Z9490M
Radius Point	1" Lth, 4-48 Thds, Stl Hard Black Oxide	Starrett PT06677B	Z9362
Radius Point	3/4" Lth, 4-48 Thds, Steel Black Oxide	Starrett PT06677A	Z9363
Radius Point	1/2" Lth, 4-48 Thds, Steel Black Oxide	Starrett PT06677	Z9364
Radius Point	1/4" Lth, 4-48 Thds, Steel Black Oxide	Starrett PT07215	Z9397

USA MADE

Special CNC-Qualified Series Roller Bearing Points

Specially manufactured Roller Bearing Points in 3/8" and 1/2" bearing sizes.
Points are constructed to allow the changing of the roller bearings, for unlimited life.
4-48 threads to fit all AGD standard Indicators



Special CNC Qualified Series Roller Bearing Points	
	Order Number
3/8" Bearing Size	Z9389
3/8" Bearing Size (M2.5 threads)	Z9388M
1/2" Bearing Size	Z9390

USA MADE





AGD Drop Dial Indicator Points

USA **MADE**

Metric Cone Points

All Points St/St and have M2.5 Threads
Corrosion Resistant Type 303 Stainless Steel

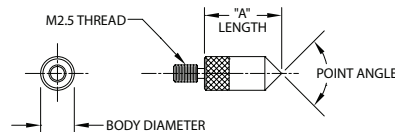

**90° Cone Point
Z8965**



**60° Cone Point
Z8966**

Metric Cone Points				
Point Angle	Length	Body Diameter	Material	Order Number
90°	5mm	5mm	St/St	Z8965
60°	10mm	5mm	St/St	Z8966
60°	15mm	5mm	St/St	Z8967
60°	20mm	5mm	St/St	Z8968

USA **MADE**

Mini Probe Points for Dial Indicators

A handy way to measure the depth of small diameter holes, pockets, and other hard to reach part features.
Steel, Black Oxide Plated.

Made in USA

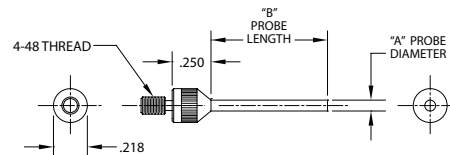

Mini Probe Points			
"A" Probe Diameter	"B" Probe Length	"C" Body Length	Order Number
.020"	1/4"	1/4"	Z2410
.030	1/2	1/4	Z2412
.050	3/4	1/4	Z2414
.070	3/4	1/4	Z2416
.090	1"	1/4	Z2418

USA **MADE**

Bell Shaped Flat Contact

3/8" wide ground flat bottom contact point. 3/8" long, measuring face is .118" thick.
Steel, case hardened, nickel plated and then ground flat and parallel on the measuring surface.

Made in USA

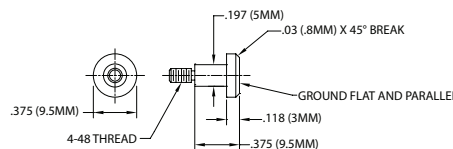

Order Number
MTI101189

USA **MADE**

Standard Ball Tip

Replacement point for all standard AGD 4-48 Dial Indicators.
3/16" major diameter X 5/16" long with steel ball tip.
Steel with Black Oxide plating.

Made in USA

Order Number
Z9396

USA **MADE**

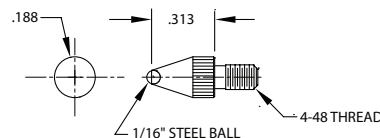

**SPECIAL ORDERS
AVAILABLE—
Small Quantities
to Large Volume**



AGD Drop Dial Indicator Points

USA  MADE

Measuring Tool,
Gaging & Fixturing
Accessories



Button Indicator Contacts—Steel & Stainless Steel

Low Carbon Steel, Case Hard, Black Oxide Plated, or 300 series Stainless

Button Indicator Contacts					
Diameter	Threads	Radius	Overall Length	Order Number	
				Steel	Stainless Steel
3/8	4-48	.373	.300	Z9355	Z9355SS
3/8	M2.5	.373	.300	Z9355M	Z9355MSS
3/8	4-48	.373	.320	Z9400	—
1/2	4-48	.500	.355	Z9356	Z9356SS
1/2	M2.5	.500	.355	Z9356M	Z9356MSS
3/4	4-48	.750	.410	Z9357	Z9357SS
3/4	M2.5	.750	.410	Z9357M	Z9357MSS
3/4	4-48	.870	.320	Z9402	—

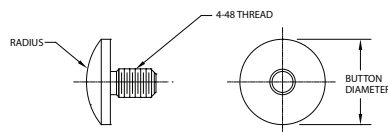

NOW AVAILABLE
IN METRIC M2.5
THREADS

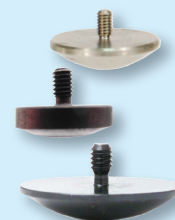

Flat Indicator Contacts—Steel & Stainless Steel

Low Carbon Steel, Case Hard, Black Oxide Plated, or 300 series Stainless

Flat Indicator Contacts				
Diameter	Threads	Thickness	Steel Order Number	Stainless Steel Order Number
1/4"	4-48	.112"	Z9365	Z9365SS
1/4	M2.5	.112	Z9365M	Z9365MSS
3/8	4-48	.093	Z9366	Z9366SS
3/8	M2.5	.093	Z9366M	Z9366MSS
1/2	4-48	.100	Z9367	Z9367SS
1/2	M2.5	.100	Z9367M	Z9367MSS
1/2	4-48	.160	Z9367TH	—
5/8	4-48	.100	Z9368	Z9368SS
5/8	M2.5	.100	Z9368M	Z9368MSS
3/4	4-48	.100	Z9370	Z9370SS
3/4	M2.5	.100	Z9370M	Z9370MSS
1	4-48	.125	Z9369	Z9369SS
1	M2.5	.125	Z9369M	Z9369MSS
1-1/2	4-48	.125	Z9371	Z9371SS
2	4-48	.125	Z9372	Z9372SS
2-1/2	4-48	.125	Z9373	—

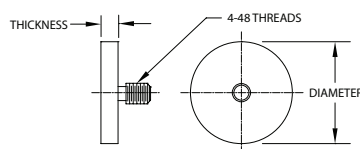

NOW AVAILABLE
IN METRIC M2.5
THREADS

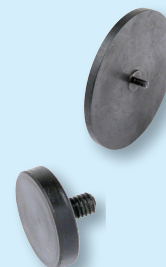

Flat Indicator Contact—2" OD w/Screw

Low Carbon Steel, Case Hard, Black Oxide Plated, .125" Thick
Drilled through Center, comes with 4-48 screw

Order Number

Z9372RT





AGD Drop Dial Indicator Points

USA **MADE**



Flat End Indicator Points—18-8 Stainless Steel—Metric

Corrosion Resistant Type 303 Stainless Steel, M2.5 Threads

Flat End Indicator Points			
"A" Length	Body Diameter	Thread	Order Number
5MM	5MM	M2.5	Z8970
10MM	5MM	M2.5	Z8971
15MM	5MM	M2.5	Z8972
20MM	5MM	M2.5	Z8973
25MM	5MM	M2.5	Z8974
30MM	5MM	M2.5	Z8975

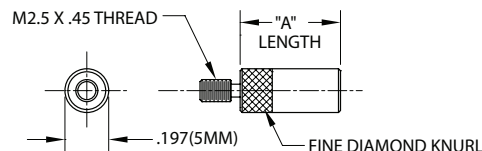

USA **MADE**



Shell End Indicator Points—18-8 Stainless Steel—Metric

Corrosion Resistant Type 303 Stainless Steel, M2.5 Threads

Shell End Indicator Points			
"A" Length	Body Diameter	Thread	Order Number
5MM	5MM	M2.5	Z8980
10MM	5MM	M2.5	Z8981
15MM	5MM	M2.5	Z8982
20MM	5MM	M2.5	Z8983
25MM	5MM	M2.5	Z8984

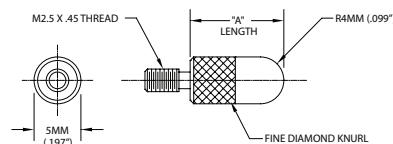

USA **MADE**



Tapered Indicator Contacts—18-8 Stainless Steel

Corrosion Resistant Type 303 Stainless Steel

Tapered Indicator Contacts		
Body Length	Threads	Stainless Steel
		Order Number
1/2"	4-48	Z9379SS
5/8	4-48	Z9374SS
13/32	4-48	Z9375SS
13/32	M2.5	Z9375MSS
1	4-48	Z9376SS
1	M2.5	Z9376MSS
1-1/4	4-48	Z9400SS
1-1/2	4-48	Z9377SS
1-1/2	M2.5	Z9377MSS
2	4-48	Z9378SS
2	M2.5	Z9378MSS

**NOW AVAILABLE
IN METRIC M2.5
THREADS**

USA **MADE**

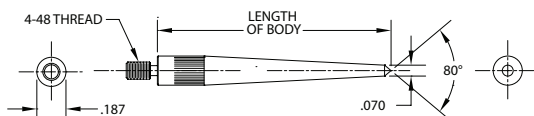

**SPECIAL ORDERS
AVAILABLE—
Small Quantities
to Large Volume**





Contact Point Rings/Sets

USA MADE

Accurate 10 Pc. Contact Point Set

A top quality contact assortment for the professionally equipped dial indicator. Includes the following contacts, secured in a machined ring suitable for workbench or flat storage.

10 Stainless Steel Contacts in Aluminum ring stand.

Made in USA

Accurate Contact Point Ring—Set		
Qty	Description	Order Number
1	3/8 CNC Qualified Roller Bearing	Z9389
1	1/2 CNC Qualified Roller Bearing	Z9390
1	3MM Ruby Tip x 1/2" long	Z6974
1	Flat Steel Point 7/32 diameter X 1/4 long	Z9311
1	Flat Steel Point 7/32 diameter X 1/2 long	Z9313
1	Flat Steel Point 7/32 diameter X 3/4 long	Z9315
1	Flat Steel Point 7/32 diameter X 1-1/4 long	Z9318
1	Flat Contact 1/4 wide	Z9365
1	Flat Contact 1/2 wide	Z9367
1	.060 Steel Ball Tip, 5/16 long	Z9396

Set Order Number

Z9013

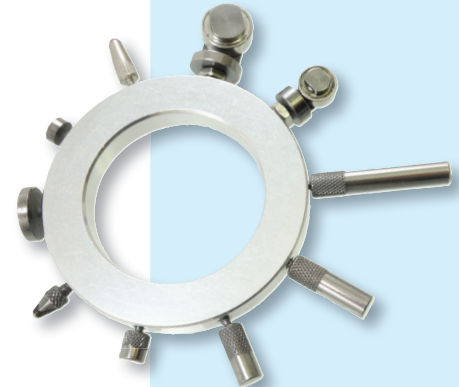
USA MADE

Accurate 14 Pc. Contact Point Set

Functional Equivalent to Starrett Set 25R

14 Contacts in metal ring stand. **Made in USA**

A top quality contact assortment for the professionally equipped dial indicator.

Includes the following contacts, secured in a machined ring suitable for workbench or flat storage.

Starrett Contact Point Ring—Set 25R			
Qty	Description	Functional Equivalent	Order Number
1	3/8 Ground Flat Bottom Contact, 3/8" Lth, 4-48 Thds	Starrett PT06632/2 - 70790	Z9492
1	1/2 Ground Flat Bottom Contact, 3/8" Lth, 4-48 Thds	Starrett PT06632/3 - 70791	Z9491
1	1/2 Button Contact, 4-48, Steel Black Oxide	Starrett PT06632/4 - 70792	Z9356
1	3/8 Button Contact, 4-48, Steel Black Oxide	Starrett PT06632/5 - 70793	Z9355
1	1/2" Lth 90 Degree Cone Point Contact, 4-48, Steel Black Oxide	Starrett PT06632/6 - 70794	Z9332
1	1/16" Ball Contact, 1/4" Lth, 4-48 Steel Black Oxide	Starrett PT06632/7 - 70795	Z9398
1	5/8" Lth Tapered Contact, 4-48, Steel Black Oxide	Starrett PT06632/8 - 70796	Z9497
1	Button Contact, 13/64" Dia X 5/32" Lth, 4-48, Steel Black Oxide	Starrett PT06632/9 - 70797	Z9496
1	Shock Absorbing Contact Point, 4-48	Starrett #28 - 50199	Z9490
1	9/32 Lth Cone Point, Stl Hard, Black Ox, 4-48 Thds	Starrett PT06632/10	Z9361
1	1" Lth Polished Radius Point, Stl Hard Black Ox, 4-48 Thds	Starrett PT06677B	Z9362
1	3/4" Lth Polished Radius Point, Steel Black Ox, 4-48 Thds	Starrett PT06677A	Z9363
1	1/2" Lth Polished Radius Point, Steel Black Ox, 4-48 Thds	Starrett PT06677	Z9364
1	1/4" Lth Polished Radius Point, Steel Black Ox, 4-48 Thds	Starrett PT07215	Z9397

Set Order Number

Z9414

USA MADE

Fowler 6 Pc. Contact Point Set

Made in USA

Set Order Number

FOW52-525-065

USA MADE

Accurate
Manufactured
Products
Group

Phone: 317-472-9000 • FAX: 317-472-9010 • email: sales@ampg.com • www.ampg.com



H13



Gage Ball Tips

USA **MADE**

Gage Balls—Chrome Alloy Steel

A complete line of Grade 25 (accurate to 25 millionths) Chrome Alloy Steel Gage Balls, mounted on our stems with 4-48 threads.

These Gage Ball Tips attach directly to Dial Indicators, or use the attachments listed on the following page to attach them to Calipers.

Ball is Chrome Alloy Steel. Bodies are made from corrosion resistant Type 303 Stainless Steel.

Made in USA

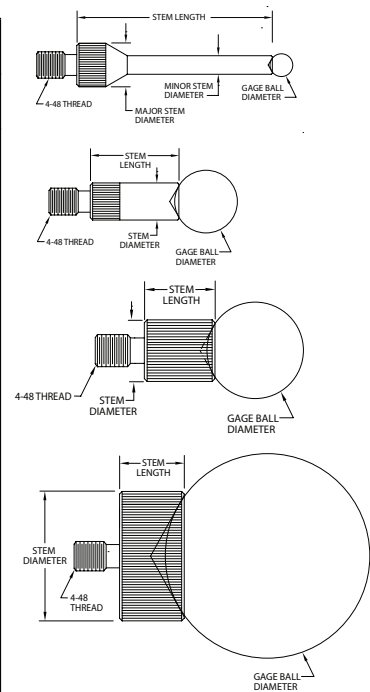

Gage Ball Tips					
Gage Ball Diameter	Stem Length	Major Stem Diameter	Minor Stem Diameter	Thread	Order Number
0.0310"	.600"	.156"	.025"	4-48	Z6931
0.0460	.710	.156	.040	4-48	Z6932
0.0625	.710	.156	.040	4-48	Z6933
0.0780	.830	.156	.058	4-48	Z6934
0.0938	.830	.156	.058	4-48	Z6935
0.1250	.800	.156	.100	4-48	Z6936
0.1562	.800	.156	.100	4-48	Z6937
0.1562	.800	.156	.100	M2.5	Z6937M
0.1875	.375	.156	.156	4-48	Z6938
0.2188	.375	.156	.156	4-48	Z6939
0.2500	.250	.218	.218	4-48	Z6940
0.2812	.250	.218	.218	4-48	Z6941
0.3125	.250	.218	.218	4-48	Z6942
0.3438	.250	.218	.218	4-48	Z6943
0.3750	.250	.218	.218	4-48	Z6944
0.4060	.250	.218	.218	4-48	Z6945
0.4060	.250	.218	.218	M2.5	Z6945M
0.4370	.250	.218	.218	4-48	Z6946
0.4680	.250	.218	.218	4-48	Z6947
0.5000	.250	.218	.218	4-48	Z6948
0.5310	.250	.218	.218	4-48	Z6950
0.5625	.250	.312	.312	4-48	Z6951
0.5937	.250	.312	.312	4-48	Z6952
0.6250	.250	.312	.312	4-48	Z6953
0.6250	.250	.312	.312	M2.5	Z6953M
0.6560	.250	.312	.312	4-48	Z6954
0.6870	.250	.312	.312	4-48	Z6955
0.7180	.250	.312	.312	4-48	Z6956
0.7500	.250	.312	.312	4-48	Z6957
0.7812	.250	.312	.312	4-48	Z7100
0.8125	.250	.312	.312	4-48	Z7101
0.8750	.250	.500	.500	4-48	Z7102
0.9375	.250	.500	.500	4-48	Z7103
1.0000	.250	.500	.500	4-48	Z7104
1.0625	.250	.500	.500	4-48	Z7105
1.1250	.250	.500	.500	4-48	Z7106
1.1875	.250	.500	.500	4-48	Z7107
1.2500	.250	.500	.500	4-48	Z7108

USA **MADE**

**SPECIAL ORDERS
AVAILABLE—
Small Quantities
to Large Volume**



***Note:** These tips are designed for use as an indicator point, and are not to be used for sizing and gaging applications where side pressure is present.*



Drop Dial Indicator Extension Points **USA MADE**

Indicator Extension Points—Stainless Steel

Use to gain extra length. 7/32" diameter points have 4-48 internal and 4-48 external threads. Made from corrosion resistant Type 303 Stainless Steel.

Indicator Extension Points	
Length	Order Number
1/2"	Z9391SS
3/4	Z9392SS
1	Z9339SS
1-1/4	Z9393SS
1-1/2	Z9343SS
1-3/4	Z9394SS
2	Z9340SS
2-1/2	Z9351SS
3	Z9341SS
4	Z9352SS
6	Z9353SS

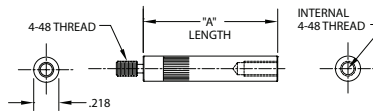
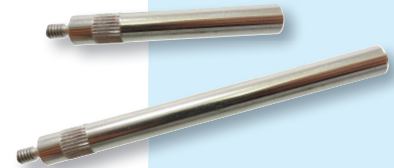
USA MADE

Metric Indicator Extension Points

Use to gain extra length. 7/32" diameter points have M2.5 X 0.45 Internal and M2.5 X 0.45 External threads. Made from corrosion resistant Type 303 Stainless Steel.

Metric Extension Points	
Length	Order Number
1/2"	Z9391SS-M
3/4	Z9392SS-M
1	Z9339SS-M
1-1/4	Z9393SS-M
1-1/2	Z9343SS-M
1-3/4	Z9394SS-M
2	Z9340SS-M
2-1/2	Z9351SS-M
3	Z9341SS-M
4	Z9352SS-M
6	Z9353SS-M

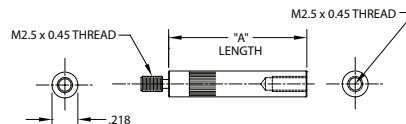
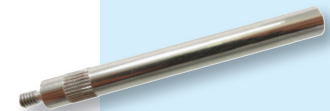
USA MADE

Extension Point Kit

Handy kit of the most used Extension Points with 4-48 internal and external threads. Contains 1 each of 1", 2", and 3" extensions. Packaged in clear plastic tube. Made from corrosion resistant Type 303 Stainless Steel.

Order Number
Z9350SS

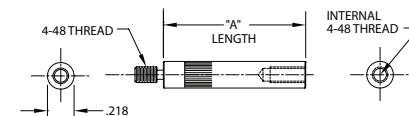
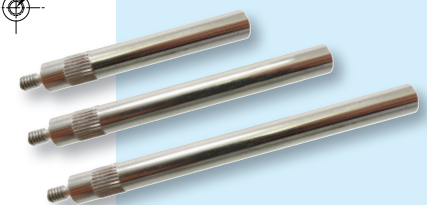
USA MADE



Indicator Conversion Points & Accessories **USA MADE**



Adapt-A-Tip

Converts Test Indicator Tips to 4-48 Threads

This point converts any Test Indicator Tip to a 4-48 thread, enabling it to be used on any standard AGD Dial Indicator. Allows you to measure small pockets, grooves, recesses, and holes. Low Carbon Steel, Nickel Plated.

Made in USA

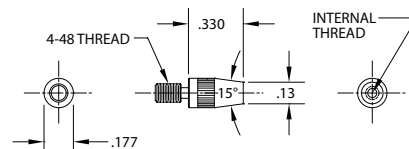

Adapt-A-Tip					
Converts Test Indicator Tips to 4-48 Threads					
Fits Test Indicator Tips	Internal Thread	External Thread	Diameter	Length	Order Number
Tesa, Brown & Sharpe, Girod	M1.4 X 0.30	4-48	3/16"	.330"	Z6995
Interapid, Teclock, Peacock, Mitutoyo	M1.7 X .35	4-48	3/16	.330	Z6996

USA MADE



Metric to English Conversion Point

4-48 Internal Threads to M2.5 External Threads. Use your standard Inch AGD points in Dial Indicators with Metric threads. Point is 7/32" diameter, 1/2" length, with 4-48 internal tap and M2.5 X 0.45 male stud. Corrosion Resistant Type 303 Stainless Steel

Made in USA

Order Number
Z9344SS

USA MADE

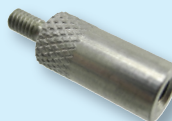
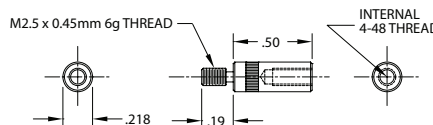

English to Metric Conversion Point

M2.5 X 0.45 Internal Threads to 4-48 External Threads. Use your Metric AGD points in Standard Dial Indicators. Point is 7/32" diameter, 1/2" length, with M2.5 X 0.45 internal tap and 4-48 male stud. Corrosion Resistant Type 303 Stainless Steel

Made in USA

Order Number
Z9342SS

USA MADE

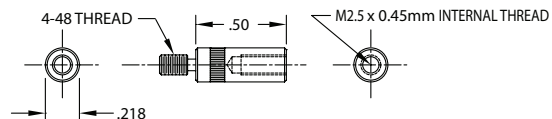

**SPECIAL ORDERS
AVAILABLE—
Small Quantities
to Large Volume**



Indicator Chuck

- Low Carbon Steel, black oxide plated
- .014-.040 chucking capacity

Made in USA



Dial Indicator and stand not included

Thread	Order Number
4-48	Z1020
M2.5	Z1020M

USA MADE



Dial Indicator Backs

USA  MADE

Measuring Tool,
Gaging & Fixturing
Accessories



Indicator Backs—Black Anodized Aluminum	
Description	Order Number
Flat Back for Accu Pro AGD 2	Z0256
Lug Back for Accu Pro AGD 2	Z0257
Offset Lug Back for Accu Pro AGD 2	Z0258
Post Back for Accu Pro AGD 2	Z0259
Adjustable Back for Accu Pro AGD 2	Z0261
Flat Back for Fowler Chinese Indicator	Z0300
Lug Back for Fowler Chinese Indicator	Z0301
Offset Lug Back for Fowler Chinese Indicator 52-525-010	Z0302
Post Back for Fowler Chinese Indicator 52-525-020	Z0303
Screw Back for Fowler Chinese Indicator	Z0304
Flat Back for Fowler Sylvac Indicator	Z0310
Lug Back for Fowler Sylvac Indicator 52-525-005	Z0311
Offset Lug Back for Fowler Sylvac Indicator 52-525-010	Z0312
Post Back for Fowler Sylvac Indicator 52-525-020	Z0313
Screw Back (1/4-20) for Fowler Sylvac Indicator 52-525-025	Z0314
Flat Back for Fowler Baker AGD 2 Drop Indicator (3 Hole)	Z0316
Lug back for Fowler Baker Indicator	Z0317
Offset Lug Back for Fowler Baker Indicator	Z0318
Post Back for Fowler Baker Indicator 52-525-020	Z0323
Screw Back for Fowler Baker Indicator 52-525-025	Z0324
Adjustabel Back for Fowler Baker Indicator 52-525-030	Z0325
Flat Back for Teclock Indicator AGD 1	Z0370
Lug Back for Teclock Indicator AGD 1	Z0371
Lug Back for Teclock Indicator AGD 2	Z0376
Flat Back for B&S Indicator AGD 2 (3 Hole)	Z0822

USA  MADE



Accurate
Manufactured
Products
Group

Phone: 317-472-9000 • FAX: 317-472-9010 • email: sales@ampg.com • www.ampg.com



H17



Magnetic Back System for Dial Indicators

USA **MADE**

A versatile, secure, and time saving system for mounting any Dial Indicator to any metal surface.

Applications include mounting on machine tools for in process gaging applications, set ups, and many other uses.

System consists of our standard magnetic mounting base, with interchangeable backs to fit most AGD group 1 and 2 Dial Indicators.

Made in USA

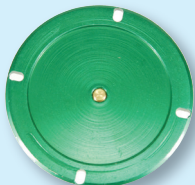
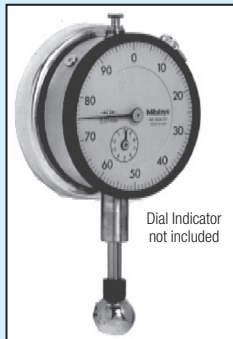

Z2692-Universal Back

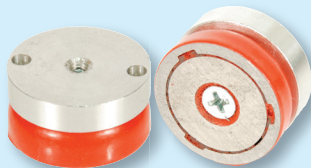

Z2700-Mag Base & Indicator Back

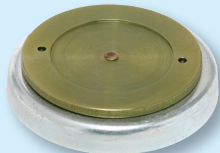

Z2705-Mag Base & Indicator Back

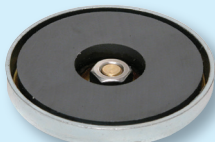

Z2690-Magnetic Base

Magnetic Back System for Dial Indicators	
Description	Order Number
Mag Base ONLY—with 8-36 Mounting Stud	Z2690
Plain Back—2" Aluminum Flat Back—NO HOLES (you drill to fit your indicator)	Z2691
Universal Back—4 elongated holes for non standard Indicator Backs	Z2692
Sets—Mag Base + Indicator Back	
AGD 1 - Fits Peacock, MTI, Enco	Z2700
AGD 1 - Fits Enco (00468371)	Z2701
AGD 2 - Fits Ames	Z2705
AGD 2 - Fits SPI (Inch)	Z2706
AGD 2 - Fits SPI (Metric)	Z2707
AGD 2 - Fits Brown & Sharpe (3 hole pattern)	Z2710
AGD 2 - Fits Federal	Z2715
AGD 2 - Fits Helios	Z2720
AGD 2 - Fits Kaefer	Z2725
AGD 2 - Fits MTI, Peacock, Enco	Z2730
AGD 2 - Fits Starrett	Z2735
AGD 2 - Fits Teclock	Z2740
AGD 2 - Fits Scherr Tumico (S-T) & Sears	Z2745
AGD 2 - Fits SPI 24-300 series	Z2750
AGD 2 - Fits SPI Amtos Chinese Indicators	Z2755
AGD 2 - Fits Brown & Sharpe black face (4 hole pattern)	Z2760
AGD 2 - Universal Back + Magnet	Z2765
AGD 2 - Fits Brown & Sharpe 14.82023 Indicator	Z2770
AGD 2 - Fits Fowler Chinese Indicator	Z2772
AGD 2 - Fits Fowler Baker Indicator	Z2773
AGD 2 - Fits Fowler British Indicator Gage	Z2774

Base dimensions:

2" round X .340 Thick with 60 Lb Pull

Aluminum Backs made from 1/8" thick

Aluminum, anodized.

USA **MADE**

**SPECIAL ORDERS
AVAILABLE—**

**Small Quantities
to Large Volume**



Indicator Bases, Stands, & Accessories

USA  **MADE**

Measuring Tool,
Gaging & Fixturing
Accessories



Dial Indicator Depth Bases

Precision hardened and ground Depth Base accepts any standard AGD Dial Indicator with 3/8" stem. Ground flat and parallel on both top and bottom surfaces. Set screw in bases holds Indicator in place. Black Oxide plated.

Made in USA

Dial Indicator Depth Base	
Description	Order Number
2-1/2" Long Base, 3/4" High, 5/8" Thick	Z9228
4" Long Base, 3/4" High, 5/8" Thick	Z9229

USA  **MADE**

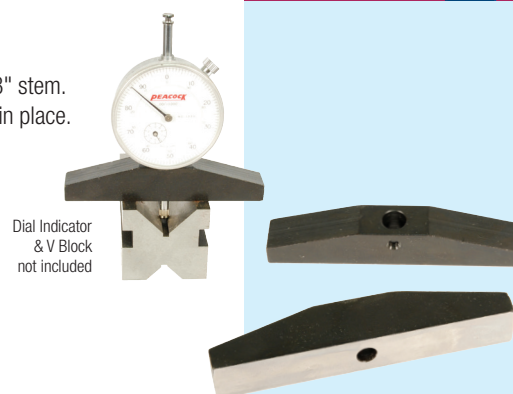

Dial Indicator Depth Bases—Metric

Accepts Dial Indicators with 8mm stem. Ground flat and parallel on both top and bottom surfaces. Set screw in bases holds Indicator in place. Black Oxide plated.

Metric Dial Indicator Depth Base	
Description	Order Number
65mm Long Base, 19mm High, 16mm Thick	Z9228M
100mm Long Base, 19mm High, 16mm Thick	Z9229M

USA  **MADE**

Indicator Measuring Stand

Perfect for turning any standard AGD Dial Indicator with 3/8" diameter stem into a thickness measuring device, or special gaging device. Perfect for measuring wall thickness and most conical measurement applications.

Features:

- Lightweight and sturdy bench tool.
- Non skid bottom prevents rocking or tipping of stand.
- Anodized aluminum resists corrosion.
- Measuring anvil marked to facilitate repetitive measurements.
- 3-3/4" maximum height for measurements.
- 1-5/8" maximum length for measurements.

Base: 4" long x 2-1/2" wide.
3-3/8" maximum clearance from Indicator Stem to upright rod.

Anvil: 1/8" diameter tapers to .074 diameter
2-5/16" length
Anvil made from Stainless Steel

Indicator Measuring Stand	
Description	Order Number
Dial Indicator Measuring Stand	Z8200
Anvil Tip Only	Z8201

USA  **MADE**



Indicator Stem Bushing

- Brass. Split one side for entire length.
- 5/32" ID to 3/8" OD.
- 19/32" overall length.

Order Number
Z2107



USA  **MADE**

Metric Indicator Stem Bushing

Accepts 8MM Indicator stem — converts to 3/8" diameter stem.

- Brass. Split one side for entire length.
- 5/8" head OD x .065" thick.
- 9/16" overall length.

Order Number
Z2105



USA  **MADE**

Straight Metric Indicator Stem Bushing

For Metric Dial Indicators with 8MM shanks. Allows use in any holding device built for AGD standard 3/8 Shanks.

- Accepts 8MM stem, converts to 3/8" diameter stem.
- Straight bushing, no head.
- .600" length.
- Brass, Nickel Plated.

Order Number
Z2106

USA  **MADE**



Accurate
Manufactured
Products
Group

Phone: 317-472-9000 • FAX: 317-472-9010 • email: sales@ampg.com • www.ampg.com

H19



Granite Gage Stands

Granite Gage Stands

- USA Components
- Imported Granite
- Grade A Surface Accuracy = $\pm 0.0001"$
- 6" x 6" Stand comes in Lug Mount or Stem Mount

USA MADE

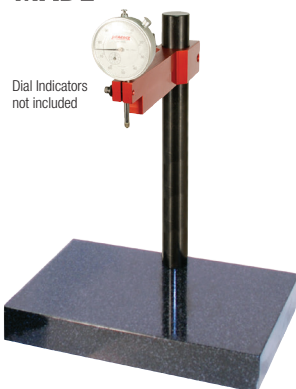
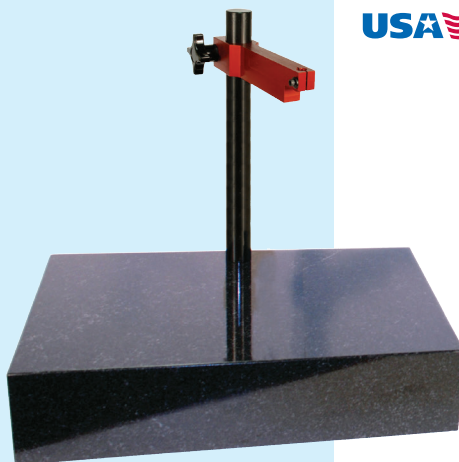

Dial Indicators
not included

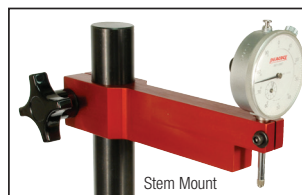
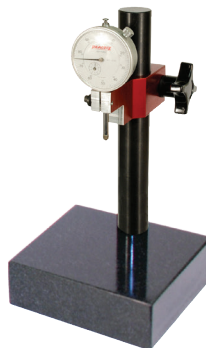

Stem Mount



Lug Mount



Carefully packaged in hard foam to protect granite and components

Granite Dial Indicator Stands						
"L" Granite Length	"W" Granite Width	"H" Granite Height	Rod Diameter	Rod Height	Indicator Mount	Order Number
6"	6"	2"	1.25"	8"	Lug Mount	STA-662
6	6	2	1.25	8	3/8 Stem Mount	STA-662-SM
8	12	2	1.25	12	3/8 Stem Mount	STA-8122
12	18	4	1.25	12	3/8 Stem Mount	STA-12184

All Components made in USA—Imported Granite

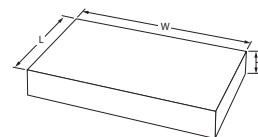

Granite Gage Stand

- Ebony Granite
- 2" thick X 6" Square
- 1" nominal diameter Post X 8" Height
- Flatness specification on the granite base is 0.0005".
- Clamp with fine adjustment fits all AGD 1,2, and 3 Indicators.
- Imported

Order Number

STA-621IMP



IMPORT

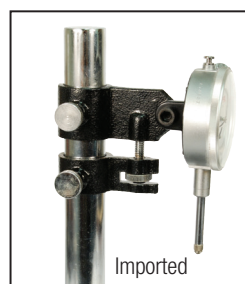

Imported

Dial Indicator not included

**SPECIAL ORDERS
AVAILABLE—
Small Quantities
to Large Volume**





Surface Plate Cleaner & Vee Blocks

Precision Surface Plate Cleaner

An exclusive formulation that is extremely effective for the cleaning and care of Granite Surface Plates. It is also easy to ship via UPS or Common Carriers. MSDS sheets are shipped with each order.

Made in USA

Precision Surface Plate Cleaner		
Description	Number per Case	Order Number
Pint	12	Z9412
Pint Spray Pump	12	Z9406
Quart	—	Z9407
1/2 Gallon	—	Z9408
Gallon	4	Z9409
5 Gallon	—	Z9410



A safe and effective formula originally invented over 10 years ago to specifications developed by a leading metrologist and marine biologist, our "Precision Surface Plate Cleaner" has been one of the most widely used for over 10 years. Works quickly and effectively, leaves no residue on the granite.

USA MADE

Mini Vee Block Set

A universal holding tool for miniature parts, used in conjunction with larger V-blocks. Ideal for grinding and/or indexing punches and pins, EDM tooling, comparator fixturing.

- Fully hardened and precision ground
- Squareness and parallelism within .0002"
- Capacity .030 to 9/32"
- **Made in USA**

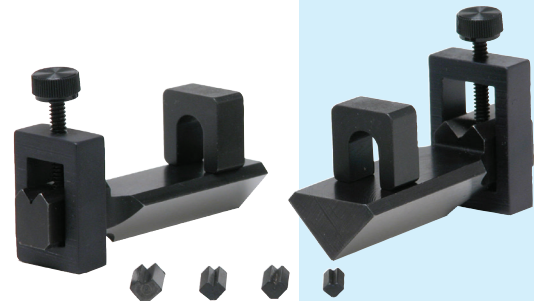

Fitted Case Includes:

- (1) **Mini V Block** – up to 5/32" capacity – with clamp, – Fits into a 3/4" and larger V Block
- (1) **Mini V Block** – holds up to 9/32" capacity – with clamp – Fits into a 1" and larger V Block
- (2) **Bridges** – clamping screw from the regular V Block will contact this part, securely mounting the Mini V Block in the V, and not interfering with the part being clamped in the Mini V System.
- (5) **Fingers** – lay on top of the cylinder being fixtured in the mini V system. The clamp contacts the finger to hold the workpiece in place.



Large V Block & Large Clamp not included.



Order Number
Z1000

USA MADE



Accurate
Manufactured
Products
Group

Phone: 317-472-9000 • FAX: 317-472-9010 • email: sales@ampg.com • www.ampg.com





Caliper Accessories

USA **MADE**

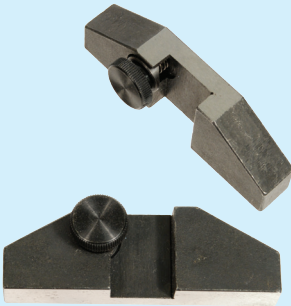

Depth Base Attachment for Calipers

This handy attachment transforms your Dial, Vernier, or Digital Caliper into a depth measurement device, without the expense of standalone Depth Micrometers.

- Fits all brands of Calipers
- Precision Ground Base
- Screw Locking Clamp
- Cold Rolled Steel
- Case Hardened .005/.010 deep
- Black Oxide Plated
- **Made in USA**

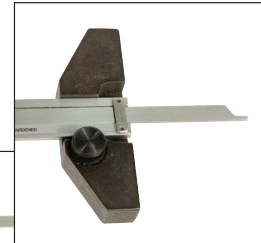
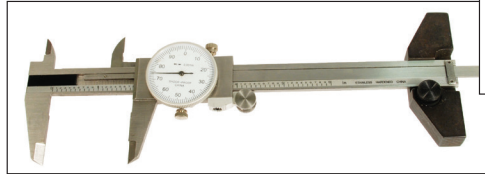

Caliper not included

Depth Base Attachment for Calipers				
Description	Base Width	Base Height	Slot Width	Order Number
3" Base - Fits 4-6" Calipers	1/2"	1"	0.675"	Z9225
4" Base - Fits 4-6" Calipers	1/2"	1"	0.675"	Z9226
5" Base - Fits 12" Calipers	1/2"	1"	0.820"	Z9227

Fits most new electronic calipers with bar at the end of the beam.

USA **MADE**



T-Bar Depth Base Attachment

This handy attachment transforms your Dial, Vernier, or Digital Caliper into a depth measurement device, without the expense of standalone Depth Micrometers.

- Fits all brands of Calipers
- Locking Screw
- Case Hardened Steel
- Black Oxide Plated
- **Made in USA**

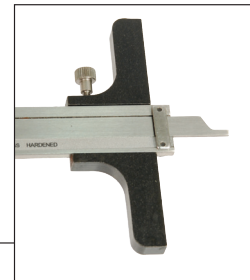
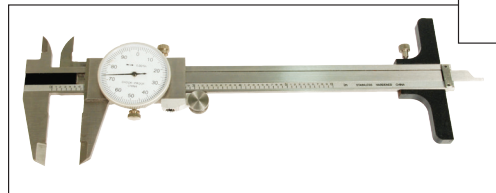

Caliper not included

T-Bar Depth Base Attachment				
Description	Base Width	Base Height	Slot Width	Order Number
3" Base - Fits 4-6" Calipers	.210"	.975"	0.620"	Z9223

USA **MADE**

**SPECIAL ORDERS
AVAILABLE—
Small Quantities
to Large Volume**



Caliper Accessories

USA  MADE

Measuring Tool,
Gaging & Fixturing
Accessories



Jaw Clamp On

- Clamps on to Caliper jaws, allows attachment of Standard Gage Balls & Depth Probes.
- Available in 3 sizes for different size Calipers.
- Right Angle Adaptor also available, which fits any of the 3 sizes of Jaw Clamp Ons.
- Steel, Black Oxide plated.
- **Made in USA**

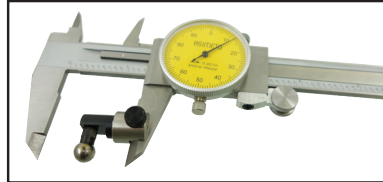
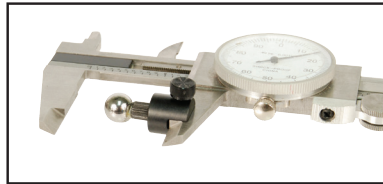

Calipers not included

Caliper Jaw Mounting Attachments	
Jaw Clamp On & Right Angle Attachment	
Description	Order Number
Jaw Clamp On for 6" Calipers (.133 max jaw width)	Z6958
Jaw Clamp on for 12" Calipers (.186 max jaw width)	Z6959
Jaw Clamp on for 18" Calipers (.245 max jaw width)	Z6983
Right Angle Adaptor fits any of the above Jaw Clamp Ons	Z6988

USA  MADE

Depth Probes

- Attach these Depth probes to 6", 12", or 18" Calipers using our Jaw Clamp Ons above.
- Available in 5 different lengths.
- Can also be attached to the Right Angle Adaptor.
- Stainless Steel
- **Made in USA**

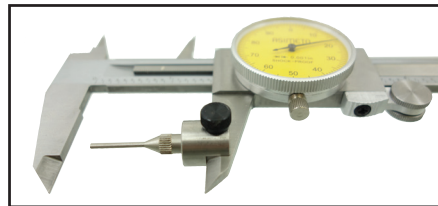

Caliper and clamp on not included

Depth Probe		
Overall Length	Probe Diameter	Order Number
1/2"	0.049"	Z6989
3/4"	0.049	Z6990
1"	0.062	Z6985
1-1/2"	0.062	Z6986
2"	0.062	Z6987

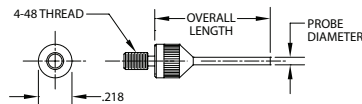

USA  MADE

Anvil Jaw Attachment

Use our Mic Anvils on your 4-6-8" Calipers

- Clamps on to Caliper jaws, allows attachment of Standard Mic Anvils.
- Steel, Black Oxide plated.
- **Made in USA**

Order Number
Z9050

USA  MADE

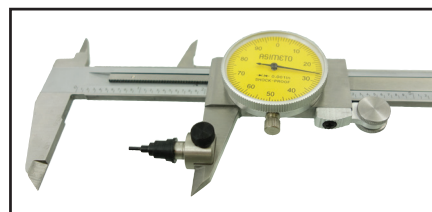

Caliper and anvil not included





Caliper Accessories

USA **MADE**

Groove Measurement Caliper Jaws

A complete range of accessory jaws that fit on any 6" Caliper, for measuring grooves. Finds many uses, including undercuts, and grooves of all types.

Works with Dial, Vernier, and Electronic tools, with measuring capacity from 0.200" to 6" in diameter. Bodies are self aligning, as they have an alignment pin built in to each pair.

Manufactured in the USA of cold rolled Steel, Black Oxide finished for protection. Sets come in plastic fitted case.

Made in USA



Z9510

Z9511



Z9512

Z9513



Z9514

Caliper not included

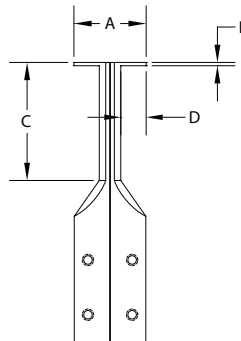

Bodies have .125" wide slot to admit Caliper Jaws

Groove Measurement Caliper Jaws				
Minimum Measurement Diameter (A)	Width of Feet (B)	Maximum Depth (C)	Groove Depth (D)	Order Number
0.200"	.015"	.400"	.050"	Z9510
0.300	.015	.625	.070	Z9511
0.600	.025	1.00	.200	Z9512
0.725	.040	1.25	.255	Z9513
External Measurement	.024	3.00	.375	Z9514

USA **MADE**



Z9500



Z9505

**SPECIAL ORDERS
AVAILABLE—
Small Quantities
to Large Volume**



Groove Measurement Caliper Jaw Sets		
Set	Description	Order Number
3 Pair Set	Includes Max. Depth of .400, .625, & 1" (Z9510, Z9511, Z9512)	Z9500
5 Pair Set	Includes All Jaws Pictured Above (Z9510, Z9511, Z9512, Z9513, Z9514)	Z9505

USA **MADE**



Caliper Accessories

USA  MADE

Measuring Tool,
Gaging & Fixturing
Accessories



Universal Caliper Accessory Kit

The original caliper jaw attachment accessory.

The square bodies attach to the jaws of any 4", 6", 8" Caliper. Threaded holes are located in the front, both sides, and the bottoms of the bodies, allowing the use of the points on any side.

Measures slots, grooves, shoulders, holes, pockets, and takes ID and OD measurements.

Corrosion Resistant Type 303 Stainless Steel

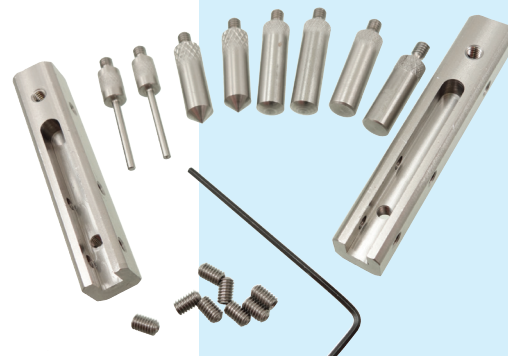

Universal Caliper Accessory Kit	
Kit contains:	Description
(2) Universal Caliper Bodies	3/8" square x 2" length. Slot for Caliper jaws is .147 wide. 4-40 holes for set screws fasten the body to the caliper jaw
(2) Flat Points	3/16 diameter x .810 length. 4-48 threads
(2) Cone Points	3/16 diameter x .810 length. 4-48 threads
(2) Stem Points	3/16 body diameter, .084 stem diameter x .820 length. 4-48 threads
(2) Ball Points	3/16 diameter x .810 length. 4-48 threads

Set Order Number
Z9020

USA  MADE

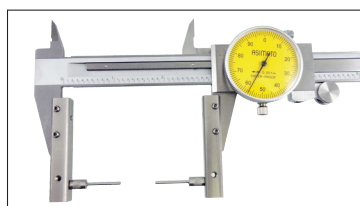

Caliper not included



Caliper not included



Jaw attachments are 3/4" across both attachments, and add approx. 1" in depth to your caliper jaws.

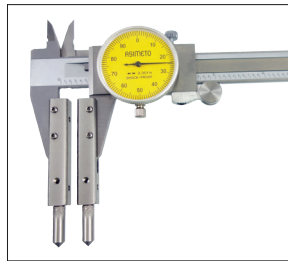

Minimum center to center measurement that can be made with this configuration is 3/8"

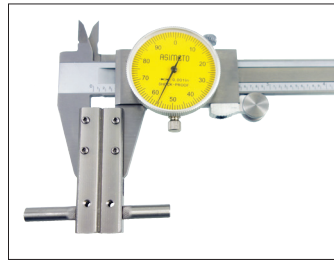

Minimum hole diameter for these attachments is 2-3/8"

Centerline Gages

- Measures centerline distances.
- Easily attaches to Dial, Vernier, and Digital Calipers.
- 60 Degree Conical Points.
- Hardened Steel with Black Oxide finish.
- Attaches in seconds with Set Screws.
- Supplied in High Impact Tubes with Allen Wrench.
- User friendly instructions.
- Made in USA

USA  MADE



Caliper not included



Centerline Gages			
"A" Diameter	"B" Overall Length	"C" Slot Width	Order Number
.375"	2-5/16"	.127"	Z9009
.500"	2.762"	.144"	Z9010

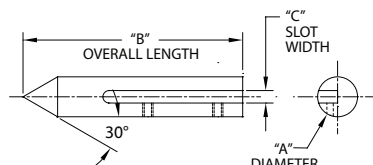

Z9009 Fits 4", 6", and 8" Calipers—Closest center to center hole dimension that can be measured is 3/8".

Z9010 fits 12" Calipers—New Size!!—Closest center to center hole dimension that can be measured is 1/2".



Phone: 317-472-9000 • FAX: 317-472-9010 • email: sales@ampg.com • www.ampg.com



H25



Caliper Accessories

USA **MADE**

Caliper Extender Attachments

A unique Caliper accessory that extends the range of your 6" Caliper **up to 91"!**

Allows both inside and outside measurements of up to 51" with your 6" Dial, Vernier, or Digital Caliper. These Extender Kits allow you to perform measuring operations without the expense of purchasing a stand alone Caliper, which could cost thousands of dollars! For the occasional measuring situation, these Kits provide the answer at a reasonable cost!

Extension bars are manufactured from high grade Aluminum, and Black Anodized with white numerals for clarity and protection. The 91" model is clear anodized, with white numerals. All mounting hardware and calibration rods are included. **Made in the USA.**

Complete instructions accompany this easy to use kit. Choose the model that fits the range of measurements you need.



Caliper not included

Caliper Extender Attachment		
Description	In addition to the tolerance on caliper, for cumulative accuracy, add the following tolerances:	Order Number
26" Extension Kit	+/- 0.003"	Z2526
36" Extension Kit	+/- 0.003"	Z2536
51" Extension Kit	+/- 0.004"	Z2551
71" Extension Kit	+/- 0.005"	Z2571
91" Extension Kit*	+/- 0.006"	Z2591

USA **MADE**

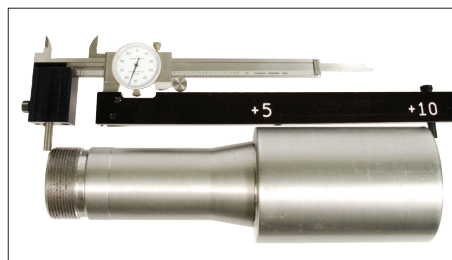

EASY TO INSTALL

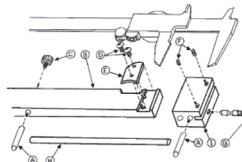

Calibration Standard for Caliper Extenders

6" calibration standard for calibrating any of the Cal Extender units. This Standard is also included with each Caliper Extender Kit.

Order Number
Z2526-4

USA **MADE**

**SPECIAL ORDERS
AVAILABLE—**

**Small Quantities
to Large Volume**



Caliper Accessories

USA  MADE

Measuring Tool,
Gaging & Fixturing
Accessories



Projection Pins for Caliper Extenders

All Caliper Extender Kits come equipped with 1/2" projection length pins. These pins extend 1/2" under the Extender Bar. You can order replacements for the originals included with your kit (Part # Z2526-10), or order the optional longer pins for added clearance. (Part #s Z2526-11 and -12)

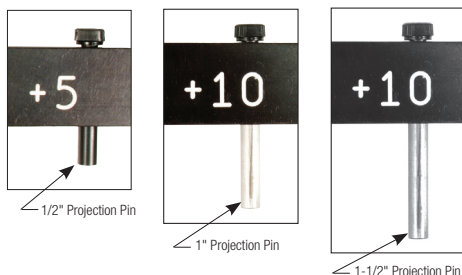

Caliper & Extender Bar not included

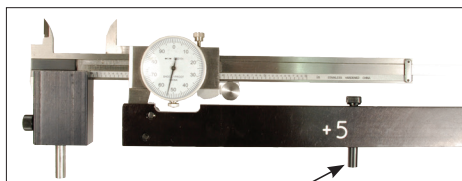

1/2" Projection Pins

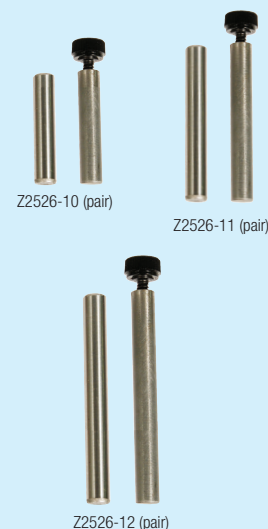

Projection Pins	
Description	Order Number
1/2" Projection Pins (pair)	Z2526-10
1" Projection Pins (pair)	Z2526-11
1-1/2" Projection Pins (pair)	Z2526-12

USA  MADE

Centerline Gage Pins for Caliper Extenders

For measuring centerline distances between hole centers.

Kit includes special end block, 2 points (.620 diameter tapers to a sharp point), special 6" centerline calibration bar, hex key, and complete instructions.

Order Number
Z2526-CG

USA  MADE

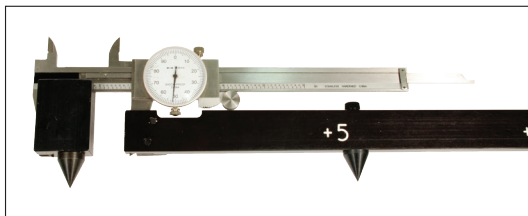

Caliper & Extender Bar not included

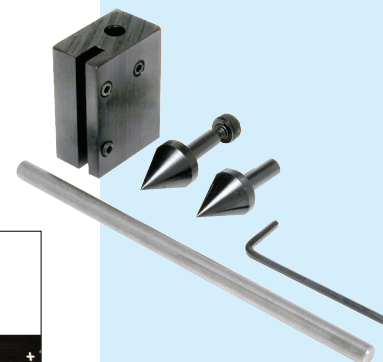

Layout Kit for Caliper Extenders

A specially adapted carbide scriber point allows you to scribe and make markings with the caliper.

The special carbide scribing point attaches to the Extender Bar, and the special projection pin with a milled flat goes into the block attached to the movable jaw of the caliper. The flat of the pin goes against the edge of your material, and you scribe the line with the scriber's carbide point.

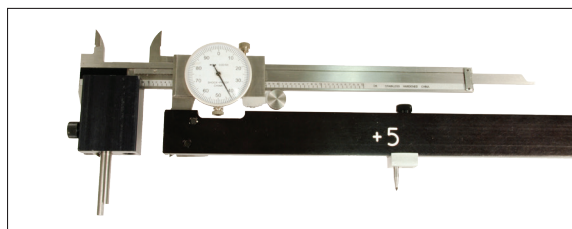

Caliper & Extender Bar not included

Order Number
Z2526-LK

USA  MADE

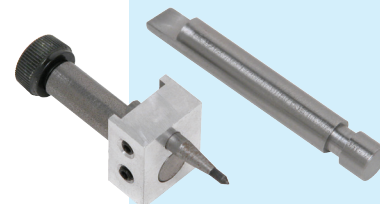

Phone: 317-472-9000 • FAX: 317-472-9010 • email: sales@ampg.com • www.ampg.com



H27



Indicator Holders & Caliper Accessories **USA MADE**

Universal Dovetail Indicator Holder

Steel & Stainless Steel Models

1/4" shank diameter with 3" reach.

This spring loaded holder locks in any of (4) 90 degree quadrants, and allows many variable angles of holding.

- Brass contact will not scar Indicator.
- Fits all dovetail equipped Indicators.
- **Made in USA**

Order Number
Z9008SS



Indicator not included



Indicator, stand, & clamp not included

USA MADE

Dual Action Dovetail Indicator Holders

- Steel with Black Oxide finish
- **Made in USA**

Dual Action Dovetail Indicator Holders		
Description		Order Number
8MM Dia. Shank x 18mm Lth	1-1/2" Overall Lth	Z9645
5/32" Dia. Shank X 11/16" Lth	1-1/2 Overall Lth	Z9646
7/32 Dia. Shank X 11/16 Lth	1-1/2 Overall Lth	Z9647
3/8 Dia. Shank X 11/16 Lth	1-1/2 Overall Lth	Z9648
3/8 Dia. Shank X 2" Lth	3" Overall Lth	Z9649

USA MADE



Indicator, stand, & clamp not included

Z Axis Caliper Mounting Kit for Mills

Holds all common Digital Calipers, for mounting on the Z axis of most Milling Machines. Simple installation with minor machining. Full instructions and all mounting hardware included.

After the initial installation, the Caliper can be mounted and taken off quickly and easily.

Made in USA

Order Number
Z9040



Caliper not included

USA MADE



**SPECIAL ORDERS
AVAILABLE—
Small Quantities
to Large Volume**





Indicator Holders & Accessories

USA **MADE**

Axial Support Bracket

Steel & Stainless Steel Models

- Used for mounting Indicators with dovetails or rods.
- 3/8" diameter body for secure clamping, with 5-1/2" overall reach.
- Bends in many directions!
- **Made in USA**

Axial Support Bracket	
Order Number	
Steel	Stainless Steel
Z9610	Z9610SS

USA **MADE**



Dovetail Stems

A complete range of Dovetail Stems to fit all applications. Stem has screw driver slot in bottom, and screws up through the dovetail to safely and securely clamp the Indicator.

- Dovetail dimension: .205" top to .220" bottom.
- Overall Length: .900"
- Corrosion Resistant Type 303 SS
- **Made in USA**

Dovetail Stems	
Shaft Diameter	Order Number
5/32"	Z7500SS
3/16	Z7504SS
7/32	Z7501SS
1/4	Z7502SS
5/16	Z7503SS



Single-Jointed Dovetail Holder

Brass Setting Nut allows orientation of the indicator in a full 360 degrees, with secure clamping. It also allows a fine adjustment for the indicator of .060 up and down.

- 1/4" diameter body for clamping
- 2-3/4" overall reach
- Fits all dovetail equipped Indicators
- **Made in USA**

Order Number
Z9660

USA **MADE**



Double-Jointed Dovetail Holder

Brass Setting Nut allows orientation of the indicator in a full 360 degrees, with secure clamping. It also allows a fine adjustment for the indicator of .060 up and down.

- 3/8" diameter body for secure clamping
- 4-1/2" overall reach
- Fits all dovetail equipped Indicators
- **Made in USA**

Order Number
Z9665

USA **MADE**





Indicator Holders & Accessories

USA MADE



Indicator Swivel Clamp

Use for clamping any indicator that has a 1/4" Rod

- Rod is 1/4" diameter X 3-1/2" Long
- Clamp accepts 1/4" rods
- Large thumb nut for easy tightening
- **Made in USA**

Order Number

Z1018

Clamps with Dovetails

For any Indicator equipped with rods or dovetails.

Used to fixture Indicators on Surface Gages, Gage Stands, Magnetic Bases, Height Gages, Transfer Stands, and many others.

- Steel with Black Oxide finish
- **Made in USA**

Indicators & stands not included



Z9620

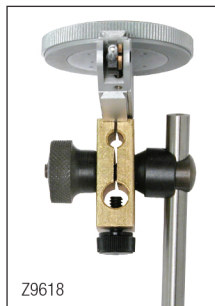

Z9618

Clamps with Dovetails

Mounting Holes	Order Number
3/8" and 7/32"	Z9600
3/8" and 1/4"	Z9601
3/8" and 5/32"	Z9602
7/32" and 5/32"	Z9620SS
1/4" and 1/8" plus adjustable hole up to 1/4"	Z9618

USA MADE



Z9600



Z9601

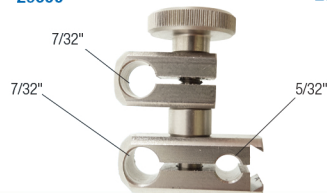

Z9620SS



Z9618

**SPECIAL ORDERS
AVAILABLE—
Small Quantities
to Large Volume**



Indicator Holders & Accessories

USA  MADE

Measuring Tool,
Gaging & Fixturing
Accessories



Test Indicator Body Clamp

For Starrett Indicators

Functional Equivalent of Starrett PT 07101F, 711-28-29-30

- Clamps to any diameter rod from 1/8–1/4"
- Steel with Black Oxide finish

Order Number
Z1010

USA  MADE

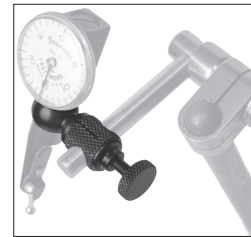

Indicator & stand not included



Use with Z1004
Long & Short Arm Attachment

Long & Short Arm Attachment

For Starrett Indicators

Functional Equivalent of Starrett PT 07104F

- Dimensions: 3/16" Dia. arms that are 13/16" & 1-3/16" in Length
- Steel with Black Oxide finish

Order Number
Z1004

USA  MADE



Use with Z1010 Body Clamp

Double-Jointed Attachment

For Starrett Indicators

Functional Equivalent of Starrett PT13301, 711-48

- Dimensions: 3/8" Dia. on one end, 1/4" Dia. on other end.
- Steel with Black Oxide finish

Order Number
Z1007

USA  MADE



Use with Z1010 Body Clamp

Ball Shank Attachment

For Starrett Indicators

Functional Equivalent of Starrett PT05119

- Replaces the ball shank of the Starrett No. 711EA Attachment
- Allows Starrett No. 711G & No. 711L Indicators to be used on holders with smaller clamp holes.
- Steel with Black Oxide finish

Order Number
Z1001

USA  MADE

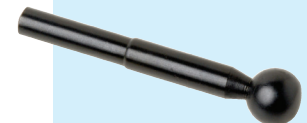

3/16" ID Coupling

For Starrett Holders PT07104F & PT13175

Functional Equivalent of Starrett PT05116, 711-46

- Dimensions: 3/16" ID x 1"
- Steel with Black Oxide finish

Order Number
Z1003

USA  MADE



Swivel Support

A swivel mount for any Indicator equipped with dovetails. The Spring loaded dovetail adjusts to fit any size.

- 3/8" diameter shank features secure clamping.
- Available with 1" long shank or extra length 3-5/8" shank.

Swivel Support	
Description	Order Number
1" Long Shank	Z9635SS
3-5/8" Long Shank	Z9636SS



USA  MADE



Accurate
Manufactured
Products
Group

Phone: 317-472-9000 • FAX: 317-472-9010 • email: sales@ampg.com • www.ampg.com



H31



Indicator Holders & Accessories

USA **MADE**

Universal Friction Holder

For Starrett Indicators

Functional Equivalent of Starrett PT13175

- 3/16" (4.8mm) Diameter Shank will fit into Starrett No. 57 & No. 257 Surface Gages, as well as chucks.
- Inserts at top of Indicator body in place of end plug
- Steel with Black Oxide finish

Order Number

Z1005

USA **MADE**

Universal Shank

For Starrett Indicators

Functional Equivalent of Starrett PT07103A

- Includes Long & Short Arm Attachment Z1004
- Shank Dimensions: 1/4" x 1/2"
- Steel with Black Oxide finish

Order Number

Z1006

USA **MADE**

Surface Gage Adapter

For Gem-type Test Indicators

Functional Equivalent of Gem #515

- Overall Length:
- Steel with Black Oxide finish

Order Number

Z1017

USA **MADE**

Angle Attachment

Accepts all Dial Indicators with standard 3/8" stem.

- 3/8" mounting hole
- 3/8" diameter by 1" long shank
- Aluminum Black Anodized
- **Made in USA**

Order Number

Z9640

USA **MADE**

Round Bar

- 7/32" diameter with .163" stepped clamping end
- 2-7/8" overall length
- .220" diameter stud
- Steel Black Oxide plated
- **Made in USA**

Order Number

Z9630

USA **MADE**

Half Round Combination Holder

A versatile holder for test indicators equipped with stems or dovetails.

- 1/4" x 2" long holding bar.
- Accepts 5/32" stem or a complete range of dovetails.
- 3 1/2" effective measuring range.
- **Made in USA**

Order Number

Z7800

USA **MADE**

The versatile connector has a hole that accepts a 5/32" stem, but also has an adjustable slot that connects to a complete range of dovetails.

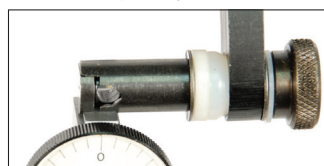

Indicator not included



Indicator & stand not included



Indicator & Height Gage Accessories **USA MADE**

Height Gage Bar & Universal Clamp Set

Popular set combining Z9627 Height Gage Bar with Z9620 Universal Clamp.

This set is one of the most widely used for Height Gage measurement applications. Holds all instruments equipped with dovetails or 7/32" diameter pins.

(OEM Part # Interapid AI-310 74.106331)



Indicator not included

Order Number

Z9627SET

USA MADE

Height Gage Bar Z9627
(1/4" x 1/2" x 3")

Universal Clamp Z9620
(7/32 & 5/32" dia. holes)

Height Gage Bar & Clamp Set

3 Pc. set combining Z9625 & 9630 Height Gage Bars with Z9600 Clamp.

This set is one of the most widely used for Height Gage measurement applications. Holds all instruments equipped with dovetails or 7/32" diameter pins.

Order Number

Z9600SET

USA MADE

Z9600

Z9625

Z9630

Rectangular Bars

For use with all height gages.

- All bars are manufactured from corrosion resistant Type 303 SS

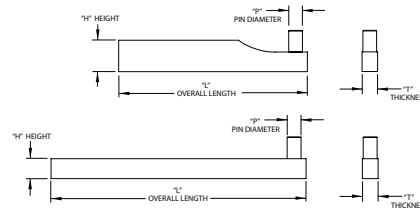

Rectangular Bars				
"T" Thickness	"H" Height	"L" Overall Length	"P" Pin Diameter	Order Number
3/16"	5/16"	3"	.220"	Z9625
5/16"	5/16"	4"	.220"	Z9626
1/4"	1/2"	3"	.220"	Z9627
1/4"	1/2"	3"	.250"	Z9628

USA MADE

Accurate Monorail Indicator Holder

For use in Milling Machines or Holders. Reach is 5-1/2". Mounting is secure and rock solid. 5/32" hole in shaft accepts Dovetail Holder with 5/32" stem (See page 183, Item Z7500). An excellent device for set ups and measurements.

Specifications:

- Aluminum Body
- 5-1/2" Reach
- Accepts 5/32" Dovetail Stems
- Locking shaft for secure mounting

Order Number

Z9861

USA MADE

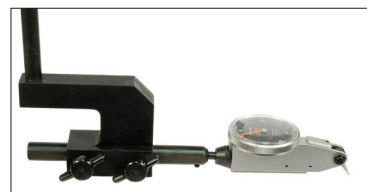

Indicator not included

Inside/Outside Diameter Groove Gages

A quick way to inspect steps, counterbores, keyways, and O-Ring grooves.

- Available in 0-6" and 6-12" ranges
- Black Anodized Aluminum

Indicator not included

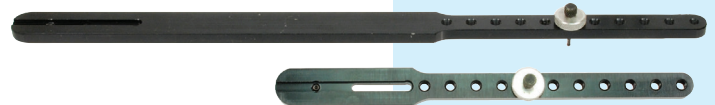
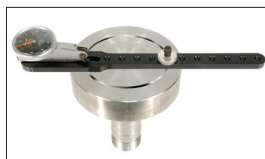

Inside/Outside Diameter Groove Gages	
Description	Order Number
0-6" Range	Z0001
6-12" Range	Z0002



USA MADE



Accurate
Manufactured
Products
Group

Phone: 317-472-9000 • FAX: 317-472-9010 • email: sales@ampg.com • www.ampg.com

H33



Indicator & Height Gage Accessories

USA **MADE**

Holding Bar with Pin

Popular accessory for use with Height Gages and other measuring stands.

- Bar is 3/16" wide by 5/16" high and 3" long.
- Adjustable pin is 7/32" diameter, which fits several of the most widely used clamps.

USA **MADE**

Holding Bar with Pin	
Description	Order Number
Holding Bar with Pin	Z9611
Holding Bar only	Z9611-1F
Holding Pin only	Z9611-3E
7/32" and 5/32" dia.	

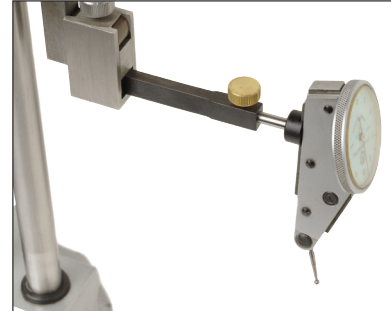

Indicator & height gage not included

Height Gage Attachment

For Starrett Height Gages

Functional Equivalent of Starrett PT 24706, 711-45

- Shank Dimensions: 3/16" x 11/32"
- Steel with Black Oxide finish

Order Number

Z1008

USA **MADE**

Height Gage Attachment

For Starrett Height Gages

Functional Equivalent of Starrett PT 08054

- Dimensions: 3/16" x 3/8"
- Steel with Black Oxide finish

Order Number

Z1002

USA **MADE**

Height Gage Attachment

For Starrett Height Gages

Functional Equivalent of Starrett PT 07127

- Dimensions: 1/8" x 5/16"
- Steel with Black Oxide finish

Order Number

Z1009

USA **MADE**

Universal Shank Holder

For Gem-type Test Indicators

Functional Equivalent of Gem #35

- Overall Length:
- Steel with Black Oxide finish

Order Number

Z1016

USA **MADE**





Indicator & Height Gage Accessories **USA MADE**

Height Gage Universal Clamp Set

The #1 problem when using any height gage accessory—every manufacturer has different size clamps on their scribes, which means many accessories cannot be clamped—the operator has to hunt through the shop for something that fits.

PROBLEM SOLVED—A universal clamp set that adjusts from 1.075" down to .575". This means that 99.9% of all attachments can be used with any height gage, whether it's Chinese, Swiss, or German. Every shop with a height gage needs one of these sets.

Set Includes:

- (1) Master Clamp
- (1) 1/8" Ht Riser
- (1) 1/4" Ht Riser
- (1) 3/8" Ht Riser
- (1) 1/2" Ht Riser
- (1) 1/4" Ht Riser with V for accomodating Round Shafts
- (1) 3/8" Ht Riser with V for accomodating Round Shafts

7 Total Items + 1 Mahogany Box

Order Number
Z9607

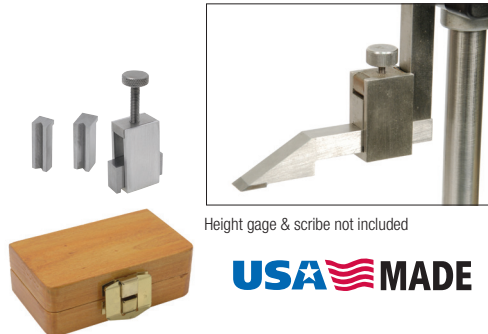

Height gage & scribe not included

USA MADE

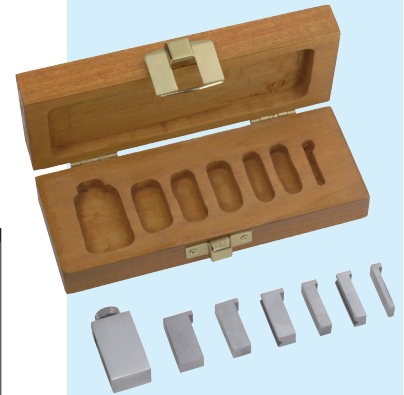

Height Gage Probe Kit

Attach Probe Styli for fine measurements

- This Height Gage Attachment lets you use any M2 threaded CMM Probe in your Height Gage
- Holder comes with (3) Ruby Ball CMM Probes—2MM Ruby Ball x 20MM Length (Z3100)
- Packed in Fitted Wood Box

Set Includes:

- (1) Attachment Bar
- (3) Z3100-Ruby Ball CMM Probes

4 Total Items + 1 Mahogany Box

Order Number
Z9609

USA MADE

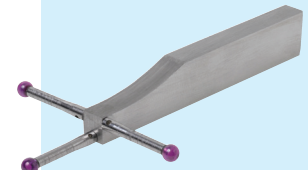

Height Gage Centering Cone Set

Quickly and easily establish the distance between two hole centers using a height gage.

- Locates the hole center as the cone is inserted into a hole.
- Measures holes from 1/16" to 1-1/16" ID
- Packed in Fitted Wood Box

Set Includes:

- (1) Holding Bar
- (2) Centering Cones

**3 Total Items
+ 1 Mahogany Box**

Order Number
Z9608

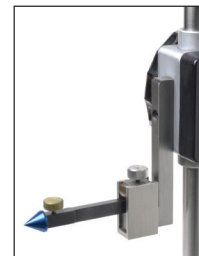



ZeroSet Indicator Set-Up Attachments **USA MADE**

ZeroSet

Perfect for Milling Machines, Magnetic Bases, and all Measuring Set Ups

A precision measuring accessory designed for any test indicator with dovetails, to quickly align the center of round work-pieces in relationship to your cutting head. Attach the ZeroSet to the collet with the hardened clamping post equipped with 1/4", 3/8", and 1/2" diameters. You can reach anywhere within an 8" radius, and you can adjust by approx. 3/8" with the fine adjustment mechanism.

Made in USA



Body mounts both ways

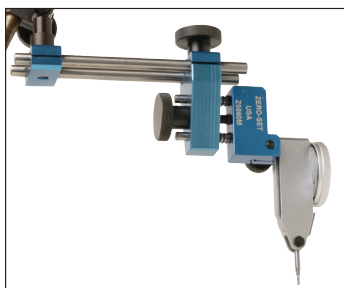

Indicator not included

Order Number

Z9860M

USA MADE

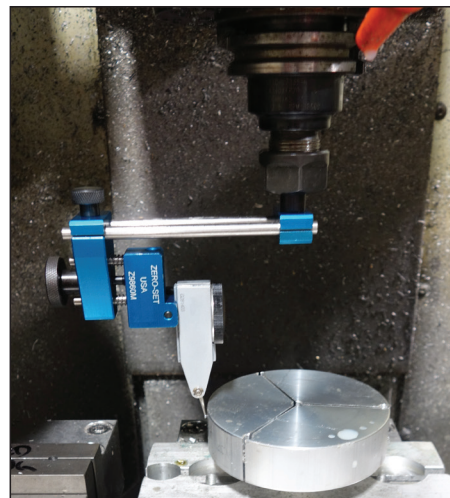

ZeroSet Universal Attachment

A unique attachment for our standard ZeroSet Indicator Accessory.

- Allows the placement of any Test Indicator with dovetails in a multitude of positions.
- Angles up to 90 degrees on either side.
- Bends both forward and backward.
- Allows for an infinite range of measurements over an extensive area.
- Attaches in seconds to our Z9860.

Made In USA

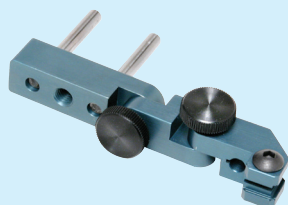

Indicator and ZeroSet not included

Order Number

Z9865M

USA MADE

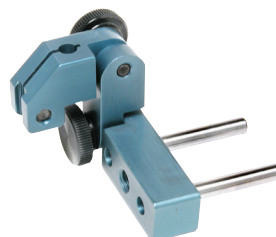

**SPECIAL ORDERS
AVAILABLE—**

**Small Quantities
to Large Volume**





Replacement Tips for Test Indicators **USA MADE**

BROWN & SHARPE Replacement Tips

Manufactured to fit BROWN & SHARPE				
M1.4 x 0.3 Threads		Order Number		
Ball Diameter	Tip Length	Steel Ball	Carbide Ball	Ruby Ball
.015	1/2"	—	Z6594	—
.040	1/2	Z6149	Z6595	—
.080	1/2	Z6205	Z6730	—
2mm	1/2	—	—	Z6300
.120	1/2	Z6295	Z6905	—
.080	11/16	—	Z6830	—
.015	1-7/16	—	Z6644	—
.040	1-7/16	—	Z6645	—
.080	1-7/16	Z6230	Z6802	—
2mm	1-7/16	—	—	Z6301
.120	1-7/16	—	Z6918	—

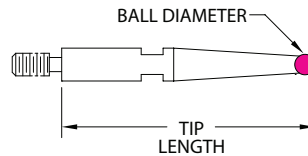

USA MADE

Note: Lengths are approximate. Tips are manufactured to fit the specific indicator.

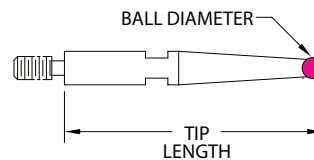

PEACOCK Replacement Tips

Manufactured to fit PEACOCK				
M1.7 x 0.35 Threads		Order Number		
Ball Diameter	Tip Length	Steel Ball	Carbide Ball	Ruby Ball
.031"	3/8"	—	Z6523	—
.038	3/8	Z6112	—	—
.078	3/8	Z6117	—	—
.080	3/8	—	Z6723	—
2mm	3/8	—	—	Z6335
.125	3/8	Z6122	—	—
.038	3/4	Z6062	—	—
.078	3/4	Z6067	—	—
2mm	3/4	—	—	—
.125	3/4	Z6072	—	—
.038	1-3/4	Z6092	—	—
.078	1-3/4	Z6097	—	—
2mm	1-3/4	—	—	—
.125	1-1/2	Z6102	—	—

USA MADE

Note: Lengths are approximate. Tips are manufactured to fit the specific indicator.





Replacement Tips for Test Indicators

USA **MADE**

PROCHECK Replacement Tips

Manufactured to fit PROCHECK				
			Order Number	
Ball Diameter	Tip Length	Thread	Steel Ball	Carbide Ball
.080	.500	M2	Z6220	—
.080	.535	M1.4	—	Z6726

Note: Lengths are approximate. Tips are manufactured to fit the specific indicator.

USA **MADE**

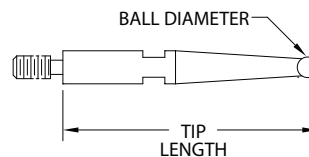

TESA Replacement Tips

Manufactured to fit TESA				
M1.4 x 0.3 Threads		Order Number		
Ball Diameter	Tip Length	Steel Ball	Carbide Ball	Ruby Ball
.015	1/2"	—	Z6530	—
.031	1/2	Z6032	—	—
.040	1/2	Z6033	Z6532	—
.060	1/2	Z6034	—	—
.080	1/2	Z6035	Z6534	—
2mm	1/2	—	—	Z6312
.090	1/2	Z6036	—	—
.120	1/2	Z6042	Z6536	—
.015	1-1/2	—	Z6538	—
.031	1-1/2	Z6044	—	—
.040	1-1/2	Z6045	Z6540	—
.060	1-1/2	Z6046	—	—
.080	1-1/2	Z6047	Z6542	—
2mm	1-1/2	—	—	Z6313
.090	1-1/2	Z6048	—	—
.120	1-1/2	Z6050	Z6544	—

Note: Lengths are approximate. Tips are manufactured to fit the specific indicator.

USA **MADE**

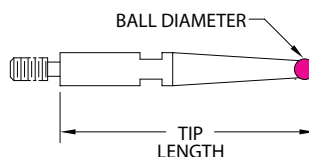

TESA Equivalents			
AMPG	Steel Ball	Carbide Ball	Ruby Ball
Z6032	—	—	—
Z6033	18.60101	—	—
Z6034	—	—	—
Z6035	18.60102	—	—
Z6036	—	—	—
Z6042	18.60103	—	—
Z6044	—	—	—
Z6045	18.60111	—	—
Z6046	—	—	—
Z6047	18.60112	—	—
Z6048	—	—	—
Z6050	18.60113	—	—
Z6312	—	—	108-080R
Z6313	—	—	109-080R
Z6530	—	108-015	—
Z6532	18.60201	108-040	—
Z6534	18.60202	108-080	—
Z6536	18.60203	—	—
Z6538	—	109-015	—
Z6540	18.60211	109-040	—
Z6542	18.60212	109-080	—
Z6544	18.60213	—	—

**SPECIAL ORDERS
AVAILABLE—
Small Quantities
to Large Volume**





Replacement Tips for Test Indicators **USA MADE**

INTERAPID Replacement Tips

Manufactured to fit INTERAPID				
M1.7 x 0.35 Threads		Order Number		
Ball Diameter	Tip Length	Steel Ball	Carbide Ball	Ruby Ball
.015	11/16"	—	Z6510	—
.031	11/16	Z6105	Z6520	—
.060	11/16	Z6200	Z6690	—
.080	11/16	Z6204	Z6738	—
2.0MM	11/16	—	—	Z6305
.093	11/16	—	Z6206	—
0.8MM	18MM	Z6804	Z6798	—
1.5MM	18MM	Z6801	Z6797	—
2.0MM	18MM	Z6800	Z6795	—
.015	13/16	—	Z6689	—
.031	13/16	Z6106	Z6525	—
.060	13/16	Z6201	Z6692	—
.080	13/16	Z6225	Z6739	—
2.0MM	13/16	—	—	Z6306
0.8MM	21MM	Z6811	Z6807	—
1.5MM	21MM	Z6810	Z6805	—
2.0MM	21MM	Z6808	Z6526	—
.031	1.450	—	Z6524	—
.080	1.450	—	Z6809	—
0.8MM	37MM	—	Z6799	—
2.0MM	37MM	—	Z6796	—
.015	1-3/4	—	Z6521	—
.031	1-3/4	—	Z6522	—
.080	1-3/4	—	Z6742	—
2.0MM	1-3/4	—	—	Z6307
0.8MM	45MM	—	Z6813	—
2.0MM	45MM	—	Z6812	—
.080	2-3/4	—	Z6879	—
.100	2-3/4	—	Z6884	—

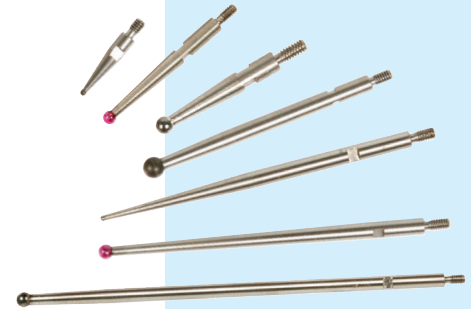
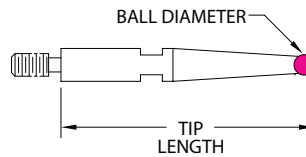
USA MADE

Note: Lengths are approximate. Tips are manufactured to fit the specific indicator.

COMPAC Replacement Tips

Manufactured to fit COMPAC			
M1.6 x 0.35 Threads		Order Number	
Ball Diameter	Tip Length	Carbide Ball	Ruby Ball
.080"	.675"	Z6737	—
.080	.720	Z6757	—
2mm	.720	—	Z6317
.120	.720	Z6915	—
.080	1.44	Z6806	—
2mm	1.44	—	Z6318
.120	1.44	Z6922	—

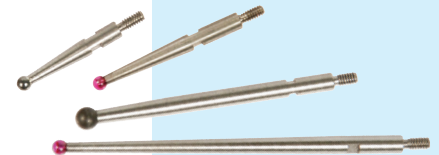
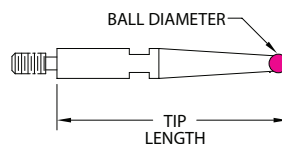
USA MADE

Note: Lengths are approximate. Tips are manufactured to fit the specific indicator.



Accurate
Manufactured
Products
Group

Phone: 317-472-9000 • FAX: 317-472-9010 • email: sales@ampg.com • www.ampg.com





Replacement Tips for Test Indicators

USA **MADE**

TECLOCK Replacement Tips



Manufactured to fit TECLOCK			
M1.7 x 0.35 Threads		Order Number	
Ball Diameter	Tip Length	Steel Ball	Ruby Ball
.038"	5/8"	Z6110	—
.078	5/8	Z6115	—
2mm	5/8	—	Z6325
.125	5/8	Z6120	—
.038	3/4	Z6060	—
.078	3/4	Z6065	—
2mm	3/4	—	Z6326
.125	3/4	Z6070	—
.038	1-1/2	Z6090	—
.078	1-1/2	Z6095	—
2mm	1-1/2	—	Z6327
.125	1-1/2	Z6100	—

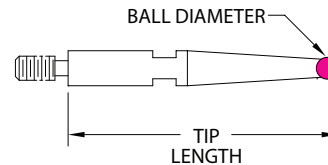

USA **MADE**

Note: Lengths are approximate. Tips are manufactured to fit the specific indicator.

FOWLER Replacement Tips



Manufactured to fit FOWLER			
M1.6 x 0.35 Threads		Order Number	
Ball Diameter	Tip Length	Steel Ball	Carbide Ball
.080"	.416"	Z6216	—
.040	.500	—	Z6590
.080	.500	—	Z6725
.120	.500	—	Z6860
.030	.768	Z6028	—
.040	.780	—	Z6610
.080	.780	Z6222	Z6785
.120	.780	—	Z6895
.040	1.500	—	Z6649
.080	1.500	—	Z6820
.120	1.500	—	Z6920
.080	2.930	Z6236	—
.080	3.077	Z6650	—

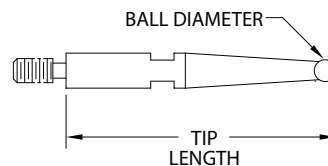

USA **MADE**

Note: Lengths are approximate. Tips are manufactured to fit the specific indicator.

**SPECIAL ORDERS
AVAILABLE—
Small Quantities
to Large Volume**





Replacement Tips for Test Indicators **USA MADE**

MITUTOYO Replacement Tips

Manufactured to fit MITUTOYO			
M1.7 x 0.35 Threads		Order Number	
Ball Diameter	Tip Length	Steel Ball	Carbide Ball
.040"	.500	—	Z6588
.015	.606	—	Z6814
.031	.606	Z6821	Z6815
.040	.606	Z6822	Z6823
.062	.606	Z6214	Z6816
.080	.606	Z6824	Z6817
.093	.606	—	Z6818
.120	.606	Z6825	Z6819
.015	.643	—	Z6838
.031	.643	Z6844	Z6839
.040	.643	Z6845	Z6840
.062	.643	Z6846	Z6788
.080	.643	Z6847	Z6841
.093	.643	Z6848	Z6842
.120	.643	Z6849	Z6843
.080	.670	—	Z6786
.040	.700	Z6150	—
.080	.700	Z6215	Z6740
.120	.700	Z6400	—

Chart continued on right

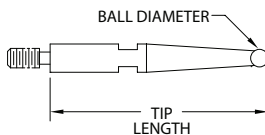

Manufactured to fit MITUTOYO			
M1.7 x 0.35 Threads		Order Number	
Ball Diameter	Tip Length	Steel Ball	Carbide Ball
.015	.900	—	Z6826
.031	.900	Z6833	Z6732
.040	.900	Z6834	Z6827
.062	.900	Z6835	Z6828
.080	.900	Z6836	Z6829
.093	.900	—	Z6831
.120	.900	Z6837	Z6832
.040	1	Z6180	—
.080	1	Z6223*	Z6790
.120	1	Z6410	—
.015	1.195	—	Z6850
.031	1.195	Z6856	Z6851
.040	1.195	Z6857	Z6852
.062	1.195	Z6793	Z6853
.080	1.195	Z6858	—
.093	1.195	—	Z6792
.120	1.195	—	Z6855
.040	1.438	—	Z6646
.080	1.438	—	Z6527
.040	1.500	Z6190	—
.080	1.500	Z6231	—
.120	1.500	Z6420	Z6789

Note: Lengths are approximate.
Tips are manufactured to fit the
specific indicator.

USA MADE

* Z6223 is manufactured for Mitutoyo 513-118 Indicators with M1.7 Threads.
This was discontinued and replaced by 513-518T which has a M1.8 X .35
Thread. P/N Z6224 is for this newer Indicator.



STARRETT Replacement Tips

Manufactured to fit STARRETT					
Ball Diameter	Tip Length	Ball Type	OEM Part Number	To Fit Starrett Model #	Order Number
1MM	13/16"	Carbide	PT23942	Starrett	Z6010
2MM	13/16	Carbide	PT23914	708, 708M	Z6011
3MM	13/16	Carbide	PT23943	709, 709M	Z6012
2MM	5/8	Carbide	PT23953	Series	Z6013
0.032	5/8"	Steel	PT23062	For Starrett 811, 811M Series	Z6015
0.032	5/8	Carbide	PT23062X		Z6016
0.078	5/8	Steel	PT22315		Z6017
0.078	5/8	Carbide	PT23953		Z6018
0.032	1-5/16	Steel	PT23064		Z6019
0.032	1-5/16	Carbide	PT23064X		Z6020
0.078	1-5/16	Steel	PT23011		Z6021
0.078	1-5/16	Carbide	PT23011X		Z6022

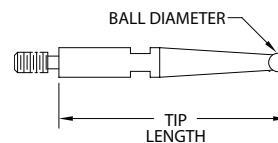

USA MADE

Note: Lengths are approximate. Tips are
manufactured to fit the specific indicator.

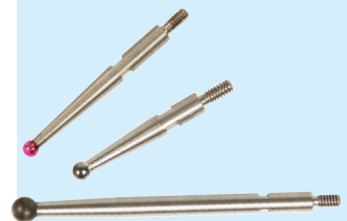

Accurate
Manufactured
Products
Group

Phone: 317-472-9000 • FAX: 317-472-9010 • email: sales@ampg.com • www.ampg.com





Replacement Tips for Test Indicators

USA **MADE**

GIROD Replacement Tips



Manufactured to fit GIROD				
Ball Diameter	Tip Length	Ball Type	Thread Size	Order Number
.040	1/2"	Carbide	M1.6 x 0.35 Threads	Z6591
.080	1/2	Carbide		Z6728
.120	1/2	Carbide		Z6911
.040	1-7/16	Carbide		Z6648
.080	1-7/16	Carbide		Z6803
.120	1-7/16	Carbide		Z6917
.040	1/2"	Carbide	after 1999 M1.4 x 0.3 Threads	Z6532
.080	1/2	Carbide		Z6730
.120	1/2	Carbide		Z6905
.040	1-7/16	Carbide		Z6645
.080	1-7/16	Carbide		Z6802
.120	1-7/16	Carbide		Z6918
2MM	1/2"	Ruby	pre 1999 M1.6 x 0.35 Threads	Z6340
2MM	1-7/16	Ruby		Z6341
2MM	1-1/2	Ruby		Z6342
2MM	1/2"	Ruby	after 1999 M1.4 x 0.3 Threads	Z6300
2MM	1-7/16	Ruby		Z6301
2MM	1-1/2	Ruby		Z6313

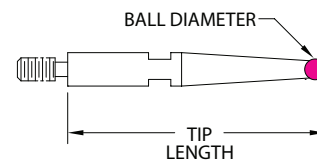

Note: Lengths are approximate. Tips are manufactured to fit the specific indicator.

USA **MADE**

KAFER Replacement Tips



Manufactured to fit KAFER		
M1.6 x 0.35 Threads		Order Number
Ball Diameter	Tip Length	Carbide Ball
.015"	.438"	Z6866
.040	.438	Z6006
.080	.438	Z6867
.015	.469	Z6868
.040	.469	Z6869
.080	.469	Z6005

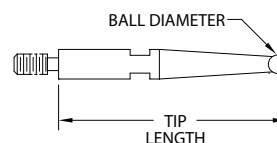

**SPECIAL ORDERS
AVAILABLE—**
**Small Quantities
to Large Volume**

USA **MADE**



Micrometer Accessories

USA  MADE

Measuring Tool,
Gaging & Fixturing
Accessories



Multi-Mike Micrometer Anvil Attachment Kit

Turns your Micrometer into 7 different Tools!

At last a kit for the machinist who must measure odd workpieces. The "MULTI-MIKE" Kit measures Shoulders, Webs, Angles, Slots, Grooves, Holes and many other hard to reach places.

This handy kit contains seven of the most sought after Accessories for outside Micrometers!

Each Anvil Attachment is held on with its own reinforced Neoprene Boot. Made in the USA to exacting standards, this kit will fit any 1-12" Micrometer, English or Metric, and all brands too!

- All 7 anvils come packaged in a protective hinged case.
- Individual Replacement Anvils are available from stock.
- Can be used singly or in pairs.
- All Anvils are 1/2" long.
- Ball Attachments are 0.200" Diameter, manufactured from Chrome Alloy Steel.
- All Anvils securely index to the Micrometer face with our heavy duty rubber holding boot.

All Anvils are hardened Steel with Black Oxide plating.
Fits .235 and .250 spindle diameters.

Order Number
Z9012

USA  MADE

Kit Contains:

- (1) Z9301 Knife Anvil Attachment
- (1) Z9302 Comparator Anvil Attachment
- (1) Z9303 Super Spline Anvil Attachment
- (1) Z9304 Spline Anvil Attachment
- (1) Z9305 Disc Anvil Attachment
- (1) Z9306 Blade Anvil Attachment
- (2) .200" Diameter Ball Attachments (Z9300)



Micrometer not included



Individual Micrometer Anvil Attachments

A must accessory for every Micrometer.
Each Anvil is 1/2" long. Comes with reinforced holding boot, and will fit on any 1-12" Micrometer.

- Anvils are hardened Steel w/Black Oxide plating
- Fits .235 and .250 spindle diameters
- **Made In USA**

Micrometer Anvil Attachments		
Anvil Type	Specifications	Order Number
Super Spline	.050" face	Z9303
Spline	.100 face	Z9304
Blade	.300 thick	Z9306
Disc	.500 face	Z9305
Knife	30 degrees	Z9301
Comparator	30 degrees	Z9302

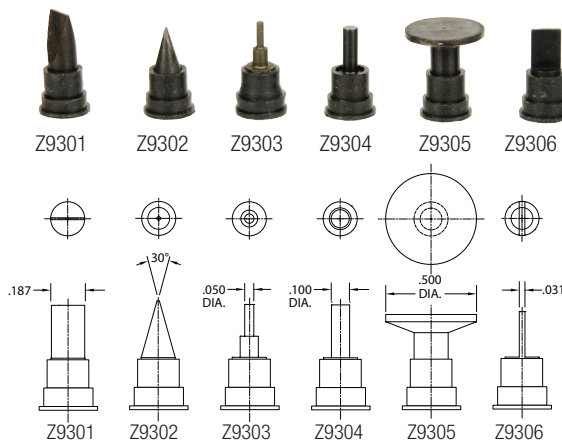

USA  MADE

Ball Attachment

The most commonly used Micrometer accessory. Allows measurement of cylindrical wall thickness and single point contact on round parts.

Fits .235, .250, & .270 diameter Spindles. Chrome Alloy Ball, 0.200" diameter for Inch version, and 5mm Chrome Alloy Ball in the metric version.

- All come with one attachment boot and (2) balls.

Ball Attachment	
Description	Order Number
.200 Inch	Z9300
5 mm Metric	Z9300M



Phone: 317-472-9000 • FAX: 317-472-9010 • email: sales@ampg.com • www.ampg.com



H43



Micrometer Accessories

USA **MADE**

Caliper Jaw Attachment for Anvils

Use our Mic Anvils on your 4-6-8" Calipers

Caliper Jaw Attachment is fastened to your Caliper jaw, and the Mic Anvil fits onto the Jaw Attachment.

• **Made In USA**

Order Number

Z9050

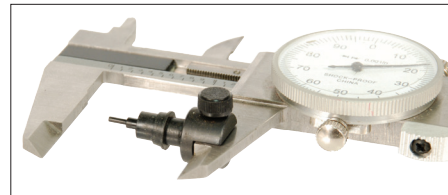

Caliper & Anvil Not Included

USA **MADE**

Thread Measuring Triangle Set

Checks for Class of Thread on all 60 degree threads. Perfect for checking thread dimensions when copying parts. Made of hardened steel with a black oxide finish.

Made in USA

Set includes:

- 2 Thread Triangles,
- 2 rubber Micrometer Holding Straps
- Comes in a protective hinged plastic case with a Unified Thread Chart

Order Number

Z9035

USA **MADE**

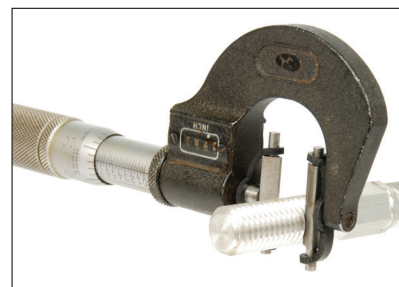

Micrometer & threaded rod not included

Thread Measuring Triangles

Checks for Class of Thread on all 60 degree threads. Perfect for checking thread dimensions when copying parts. Made of hardened steel with a black oxide finish.

Made in USA

Can be operated with one hand—
does not need to be attached to your Mic.

Order Number

Z9034

USA **MADE**

Micrometer Stand—Imported

Designed to hold round and irregular shapes for measuring, machining, grinding, and other operations.

Sturdy cast iron Micrometer Stand.
Position and viewing angle are adjustable.
Base is 6-5/8" long and 4-1/2" wide.

Order Number

STA-MIC1

Imported

Features:

- Rubber clamp faces make sure that your Mic is not marked when clamped.
- Sturdy ribbed plastic tightening knobs insure quick and secure action.
- 3/4" Maximum clamp opening.
- Spring loaded clamp keeps jaws apart, and maintain pressure.
- Rubber feet on bottom of base keep stand from moving.
- Cast Iron, with black baked enamel painted finish.



Micrometer not included





Measuring Accessories

USA **MADE**

Pin Gage Handle

Machined from solid aluminum, this premium handle can hold diameters from 1/32" to 1/2".

- Go and No Go marked on gage.
- Completely self contained, does not use any bushings.
- Available in plain Aluminum, or Green, Purple, Red, or Yellow Anodized Aluminum
- **Made in USA**

Pin Gage Handles	Order Number
Aluminum	Z2800
Green Anodized Aluminum	Z2800-GREEN
Purple Anodized Aluminum	Z2800-PURPLE
Red Anodized Aluminum	Z2800-RED
Yellow Anodized Aluminum	Z2800-YELLOW

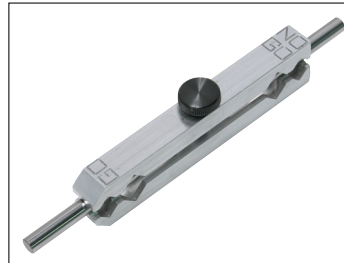

USA **MADE**

Dial Depth Gage Extensions Rods

- 4-48 Internal and External Thread.
- 3/16" diameter points.
- Knurling at the internally tapped end.
- Fits all Depth Gages with AGD standard 4-48 threads.
- Steel

USA **MADE**

Dial Depth Gage Extension Rods	
Length	Order Number
1"	Z9590
1-1/2"	Z9591
2"	Z9592
3"	Z9593
4"	Z9594
5"	Z9595
6"	Z9596
Set of Six 1", 1-1/2", 2", 3", 4", and 6" Points	Z9599

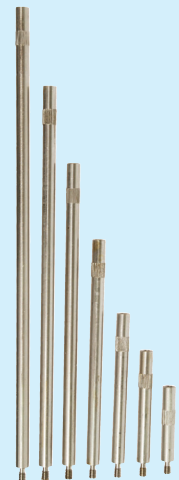

Magnetic Single Edge Finder

Firmly attaches to workpiece with integral magnet.

- **Made in USA** to exacting specifications.
- Precision ground to $\pm 0.001"$.
- Case Hardened and Plated.

Order Number
Z2500

USA **MADE**





CMM Styli

USA **MADE**

M2 Thread Styli

CMM Styli—M2 Thread									
Ball Size Length		Renishaw Functional Equivalent		Carbide Probes	Fowler	Q Mark	Order Number		
1MM Ruby	10MM	PS24R	A/5000/7802	265-1R	54-772-300	TM2-1010	Z3000		
1.5MM Ruby	10MM			—	—	TM2-1510	Z3001		
2MM Ruby	10MM			—	54-772-309	TM2-2010	Z3090		
3MM Ruby	10MM			—	54-772-329	TM2-3010	Z3290		
6MM Ruby	10MM			PS14R	A/5000/4156	265-6R	54-772-350	TM2-6010	Z3500
8MM Ruby	12MM	PS15R	A/5000/4158	265-8R	54-772-360	TM2-8015	Z3600		
1MM Ruby	20MM	PS23R	A/5000/7808	266-1R	54-772-301	TM2-1020-07	Z3010		
1.5MM Ruby	20MM						Z3011		
2MM Ruby	20MM						Z3100		
3MM Ruby	20MM						Z3300		
4MM Ruby	20MM						Z3400		
5MM Ruby	21MM						Z3405		
1.5MM Ruby	40MM						Z3407		
3MM Ruby	40MM						Z3410		

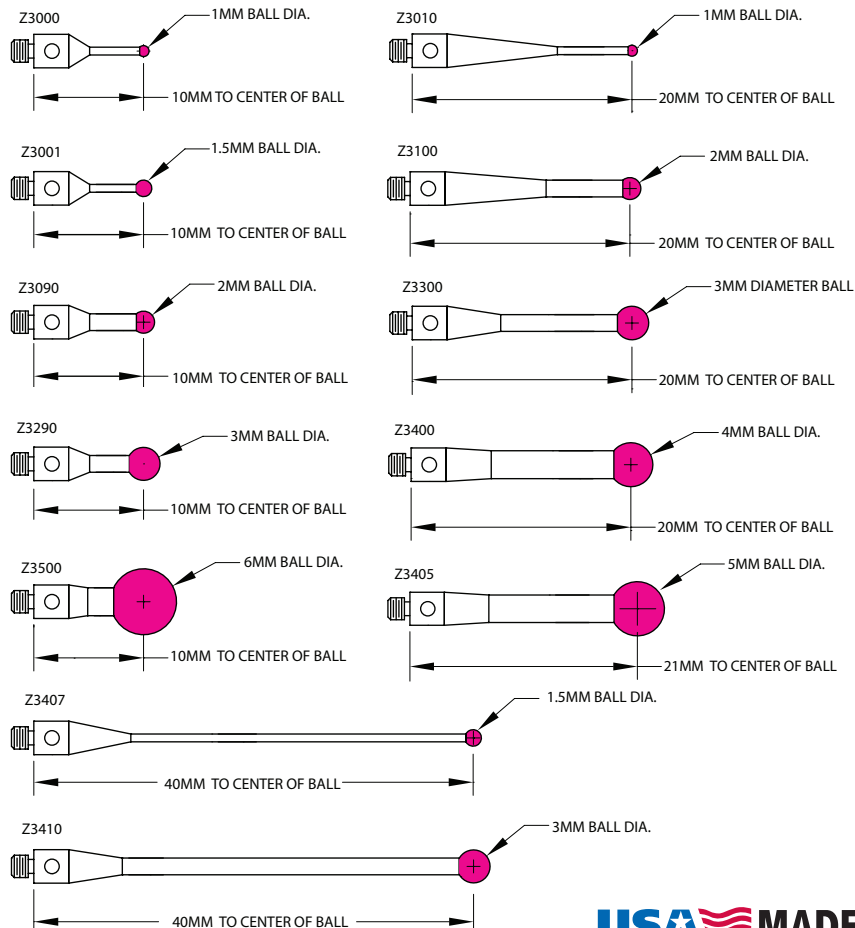

USA **MADE**

**SPECIAL ORDERS
AVAILABLE—
Small Quantities
to Large Volume**



CMM Styli

USA  MADE

Measuring Tool,
Gaging & Fixturing
Accessories



M3 Thread Styli

CMM Styli—M3 Thread						
Ball Size	Length	Renishaw Functional Equivalent		Carbide Probes	Fowler	Q Mark
1MM Ruby	10MM					
6MM Ruby	10MM					
8MM Ruby	12MM					
1MM Ruby	20MM	PS1-9R	A/5000/3551	261-1R	—	TM3-1020
2MM Ruby	20MM	PS1-10R	A/5000/3552	261-2R	—	TM3-2020
3MM Ruby	20MM	PS1-11R	A/5000/3553	261-3R	—	TM3-3020
4MM Ruby	20MM	PS1-12R	A/5000/7606	261-4R	—	TM3-4020
5MM Ruby	21MM	PS1-13R	A/5000/7630	—	—	TM3-5020
						Order Number
						Z3000M3
						Z3500M3
						Z3600M3
						Z3010M3
						Z3100M3
						Z3300M3
						Z3400M3
						Z3405M3

USA  MADE

M4 Thread Styli

CMM Styli—M4 Thread							
Ball Size	Length	Renishaw Functional Equivalent		Carbide Probes	Fowler	Q Mark	Order Number
1MM Ruby	10MM						Z3000M4
6MM Ruby	10MM						Z3500M4
8MM Ruby	12MM						Z3600M4
1MM Ruby	20MM						Z3010M4
2MM Ruby	20MM	PS2-3R	A/5000/7545	840-1R	TM4-1020	—	Z3100M4
3MM Ruby	20MM	PS2-4R	A/5000/7547	840-2R	TM4-2020	—	Z3300M4
4MM Ruby	20MM	PS2-5R	A/5000/7549	840-3R	TM4-3020	—	Z3400M4
5MM Ruby	21MM	PS2-6R	A/5000/7551	840-4R	TM4-4020	—	Z3405M4

USA  MADE

Cylinder Styli

Cylinder CMM Styli				
Thread	Cylinder Diameter	Styli Length	"C" Base Diameter	Order Number
M2 x .4	3M	13MM	3M	Z3999
M3 x .5	3M	13MM	3M	Z3999M3
M4 x .7	3M	13MM	4.75M	Z3999M4

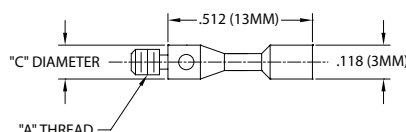

USA  MADE





CMM Styli Sets & Extensions

USA **MADE**

Fowler 11 Pc. CMM Styli Set in Plastic Case

Made in USA

Kit Contains:

- (1) Z3000 1MM RUBY CMM TRACER TIP 10 MM LTH M2X.4 THDS
- (1) Z3010 1MM RUBY BALL CMM TRACER TIP 20 MM LTH M2 X.4 THD
- (1) Z3090 2MM RUBY BALL CMM TRACER TIP 10 MM LTH M2 X.4 THD
- (1) Z3100 2MM RUBY BALL CMM TRACER TIP 20 MM LTH M2 X.4 THD
- (1) Z3290 3MM RUBY BALL CMM TRACER TIP 10 MM LTH M2 X.4 THD
- (1) Z3300 3MM RUBY BALL CMM TRACER TIP 20 MM LTH M2 X.4 THD
- (1) Z3820 CMM EXTENSION - 20MM LTH M2 X.4 THREADS ST/ST
- (1) Z3840 CMM EXTENSION - 40MM LTH M2 X.4 THREADS ST/ST
- (1) Z3860 8MM CMM PROBE SWIVEL M2 X.4 THREADS ST/ST
- (1) Z3864 CMM X-HEAD 6.5 X 6.5MM X 3MM THK, (5)M2 FEM, ST/ST
- (1) Z2999 STYLI WRENCH .050 OD TIP X 1-13/16 OAL S/S

Order Number

FOW54-772-000



USA **MADE**

M2 Thread Extensions

Stainless Steel • Made in USA

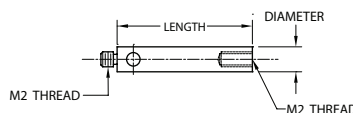

M2 Thread Extensions — Stainless Steel							
Length	Diameter	Renishaw Functional Equivalent		Carbide Probes	Fowler	Q Mark	Order Number
5MM	3MM	SE4	M/5000/3647	265-E10	54-772-810	VM2-10	Z3805
10MM	3MM	SE5	M/5000/3648	265-E20	54-772-820	VM2-20	Z3810
20MM	3MM	SE6	M/5000/4162	265-E30	54-772-830	VM2-30	Z3820
30MM	3MM	—	—	—	—	—	Z3830
35MM	3MM	—	—	—	—	—	Z3835
40MM	3MM	SE18	M/5000/7779	265-E40	54-772-840	VM2-40	Z3840
60MM	3MM	—	—	—	—	—	Z3849

USA **MADE**

M3 Thread Extensions

Stainless Steel • Made in USA

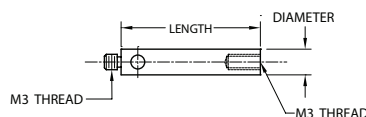

M3 Thread Extensions — Stainless Steel							
Length	Diameter	Renishaw Functional Equivalent		Carbide Probes	Fowler	Q Mark	Order Number
10MM	4MM	SE8	M/5000/7633	261-E10	—	VM3-10	Z3810M3
20MM	4MM	SE2	M/5000/3592	261-E20	—	VM3-20	Z3820M3
30MM	4MM	—	—	261-E30	—	—	Z3830M3
35MM	4MM	—	M/5000/3593	261-E35	—	VM3-35	Z3835M3
40MM	4MM	—	M/5000/3593	—	—	—	Z3840M3
60MM	4MM	—	—	—	—	—	Z3849M3

USA **MADE**

**SPECIAL ORDERS
AVAILABLE—**

**Small Quantities
to Large Volume**



CMM Extensions & Accessories

USA  MADE

Measuring Tool,
Gaging & Fixturing
Accessories



M4 Thread Extensions

Stainless Steel • Made in USA

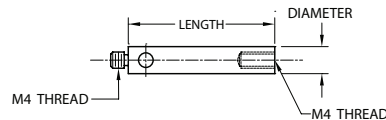

M4 Thread Extensions — Stainless Steel						
Length	Diameter	Renishaw Functional Equivalent		Carbide Probes	Fowler	Q Mark
10MM	6.3MM	—	—	823-E10	—	VM4-10
20MM	6.3MM	—	—	823-E20	—	VM4-20
30MM	6.3MM	—	—	823-E30	—	VM4-30
35MM	6.3MM	—	—	—	—	—
40MM	6.3MM	—	—	—	—	—
60MM	6.3MM	—	—	—	—	—
						Order Number
						Z3810M4
						Z3820M4
						Z3830M4
						Z3835M4
						Z3840M4
						Z3849M4

USA  MADE

Adaptor Tips—Stainless Steel

Converts your probe head to a different thread size, allowing multiple uses of CMM Styli or accessories.

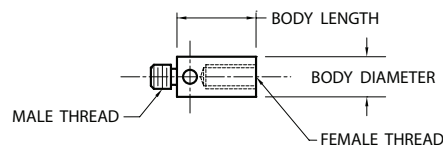

Adaptor Tips — Stainless Steel									
Male Thread	Female Thread	Body Diameter	Body Length	Renishaw Functional Equivalent		Carbide Probes	Fowler	Q Mark	Order Number
M3 X .5	M2 X .4	4MM	5MM	SA3	M/5000/4163	261-AD5	54-772-850	RM3-M2	Z3850
M2 X .4	M3 X .5	4MM	10MM	SA2	M/5000/4164	265-AD7	54-772-851	RM2-M3	Z3851
M4 X .7	M2 X .4	6.3MM	5MM	SA5	M/5000/6622	399	54-772-852	—	Z3852
M2 X .4	M4 X .7	6.3MM	15MM	—	—	—	54-772-853	RM4-M2	Z3853
M4 X .7	M3 X .5	6.3MM	10MM	SA6	M/5000/6714	—	54-772-854	—	Z3854

USA  MADE

CMM Styli Universal Wrench

Fits all Styli

Order Number
Z2999

USA  MADE

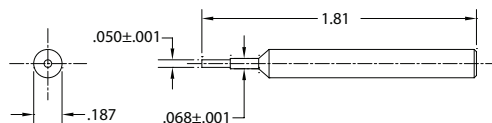

Accurate
Manufactured
Products
Group

Phone: 317-472-9000 • FAX: 317-472-9010 • email: sales@ampg.com • www.ampg.com

H49



CMM Accessories

USA MADE

CMM Crossheads

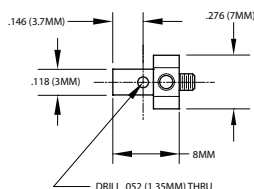
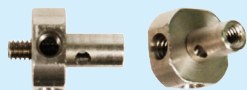

Order Number

Z3865

USA MADE



- 6.5mm square
- 3mm thick
- M2 thru thread
- M2 on all four sides

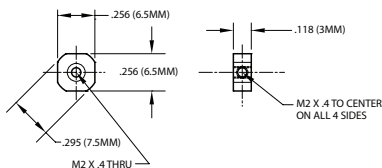

Order Number

Z3864

USA MADE

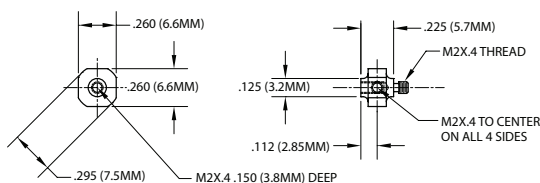

Order Number

Z3864T

USA MADE

CMM Styli Knuckles

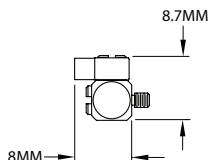

Order Number

Z3860

USA MADE

CMM Star Styli

6 Piece Set:

- (1) Z3864T CMM Crosshead
- (1) Z3005 2MM x 17.2MM Ruby Ball Probe
- (4) Z3002 2MM x 6.6MM Ruby Ball Probe

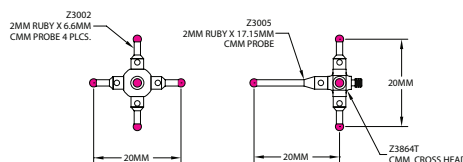

Order Number

Z3862

USA MADE

6 Piece Set:

- (1) Z3864T CMM Crosshead
- (1) Z3005 2MM x 17.2MM Ruby Ball Probe
- (4) Z3003 2MM x 11.6MM Ruby Ball Probe

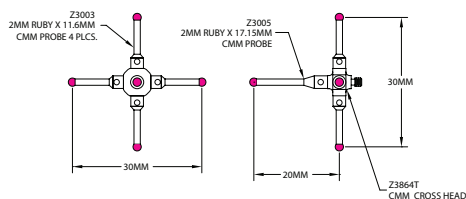

Order Number

Z3863

USA MADE

**SPECIAL ORDERS
AVAILABLE—**
**Small Quantities
to Large Volume**



Gage Balls & Hardness Penetrators

USA  MADE

Measuring Tool,
Gaging & Fixturing
Accessories



Grade 25 Chrome Alloy Steel Balls

Diameter Tolerance: +/- .0001" — Sphericity of .000025"

Grade 25 Chrome Alloy Steel Balls							
Diameter Tolerance: +/- .0001" — Sphericity of .000025"							
Diameter	Order Number	Diameter	Order Number	Diameter	Order Number	Diameter	Order Number
1/32"	BAL200CA031	3/8"	BAL200CA375	3/4"	BAL200CA750	1MM	BAL200CA039MM
3/64	BAL200CA046	13/32	BAL200CA406	25/32	BAL200CA781	3MM	BAL200CA118
1/16	BAL200CA062	7/16	BAL200CA437	13/16	BAL200CA812	5MM	BAL200CA055MM
5/64	BAL200CA078	15/32	BAL200CA468	7/8	BAL200CA875	7MM	BAL200CA275MM
				15/16	BAL200CA937		
3/32	BAL200CA093	1/2	BAL200CA500	1	BAL200CA1000		
5/32	BAL200CA156	17/32	BAL200CA531	1-1/16	BAL200CA1062		
3/16	BAL200CA187	9/16	BAL200CA562	1-1/8	BAL200CA1125		
7/32	BAL200CA218	9/32	BAL200CA593	1-3/16	BAL200CA1187		
				1-1/4	BAL200CA1250		
1/4	BAL200CA250	5/8	BAL200CA625				
9/32	BAL200CA281	21/32	BAL200CA656				
5/16	BAL200CA312	11/16	BAL200CA687				
11/32	BAL200CA343	23/32	BAL200CA718				



Grade 25 Tungsten Carbide Gage Balls

Metric & Inch Sizes

Grade 25 Tungsten Carbide Gage Balls			
Metric & Inch Sizes			
Diameter	Order Number	Diameter	Order Number
.031"	BAL25TC031	2mm	BAL25TC2MM
.040	BAL25TC040	3mm	BAL25TC3MM
.062	BAL25TC062	4mm	BAL25TC4MM
.080	BAL25TC080		
.093	BAL25TC093		



Hardness Tester Penetrators

Hardness Tester Penetrators	
Description	Order Number
1/16" Ball Penetrator with 50 extra Balls 1/4 Shank with Flat	Z0790
1/8 Ball Penetrator with 8 extra Balls 1/4 Shank with Flat	Z0791
1/4 Ball Penetrator with 2 extra Balls 1/4 Shank with Flat	Z0792
1/2 Ball Penetrator with 1 extra Ball	Z0793



USA  MADE

Diamond Penetrator

Order Number

Z9970-1



Phone: 317-472-9000 • FAX: 317-472-9010 • email: sales@ampg.com • www.ampg.com



H51



Parallel Sets



Thin Parallel Value Set

Our 1/8" thick 10 Pair Parallel Set, in custom fitted plastic box with carrying handle.

10 Pairs in Set
Hardened Steel, 6" Length X 1/8" Thick.
Heights: 1/2", 5/8", 3/4", 7/8", 1", 1-1/8", 1-1/4", 1-3/8", 1-1/2", 1-5/8"

- Parallel within 0.0008" each pair. (+/- .0004")
- Heights matched within +/- 0.001 each pair



1/4" Parallel Set

9 Pair Set, in custom fitted plastic box with carrying handle.

9 Pairs in Set
Hardened Steel, 6" Length X 1/4" Thick.
Heights: 3/4", 7/8", 1", 1-1/8", 1-1/4", 1-3/8", 1-1/2", 1-5/8", 1-3/4"

- Parallel within +/- 0.0005" each pair.
- Heights matched within +/- 0.001" each pair.



Ultra Thin 1/32" Thick 20 Pair Parallel Set

Ultra Thin Parallels are 1/32" Thick, 6" long, and heights from 1/2" thru 1-11/16".

Specifications:

+/- 0.0001" in Parallelism
Paired in Height to +/- 0.0001"
Height matched to nominal within +/- 0.001"

Thin Parallel Value Set			
Height	Length	Thickness	Order Number
1/2"	6"	1/8"	Z9980-1P
5/8"	6"	1/8"	Z9980-2P
3/4"	6"	1/8"	Z9980-3P
7/8"	6"	1/8"	Z9980-4P
1"	6"	1/8"	Z9980-5P
1-1/8"	6"	1/8"	Z9980-6P
1-1/4"	6"	1/8"	Z9980-7P
1-3/8"	6"	1/8"	Z9980-8P
1-1/2"	6"	1/8"	Z9980-9P
1-5/8"	6"	1/8"	Z9980-10P
10 Pair Set			Z9980B

1/4" Parallel Set			
Height	Length	Thickness	Order Number
3/4"	6"	1/4"	Z9985-1P
7/8"	6"	1/4"	Z9985-2P
1"	6"	1/4"	Z9985-3P
1-1/8"	6"	1/4"	Z9985-4P
1-1/4"	6"	1/4"	Z9985-5P
1-3/8"	6"	1/4"	Z9985-6P
1-1/2"	6"	1/4"	Z9985-7P
1-5/8"	6"	1/4"	Z9985-8P
1-3/4"	6"	1/4"	Z9985-9P
9 Pair Set			Z9985

Ultra Thin—1/32" Thick 20 Pair Parallel Set			
Height	Length	Thickness	Order Number
1/2"	6"	1/32"	Z9981-1P
9/16	6	1/32	Z9981-2P
5/8	6	1/32	Z9981-3P
11/16	6	1/32	Z9981-4P
3/4	6	1/32	Z9981-5P
13/16	6	1/32	Z9981-6P
7/8	6	1/32	Z9981-7P
15/16	6	1/32	Z9981-8P
1	6	1/32	Z9981-9P
1-1/16	6	1/32	Z9981-10P
1-1/8	6	1/32	Z9981-11P
1-3/16	6	1/32	Z9981-12P
1-1/4	6	1/32	Z9981-13P
1-5/16	6	1/32	Z9981-14P
1-3/8	6	1/32	Z9981-15P
1-7/16	6	1/32	Z9981-16P
1-1/2	6	1/32	Z9981-17P
1-9/16	6	1/32	Z9981-18P
1-5/8	6	1/32	Z9981-19P
1-11/16	6	1/32	Z9981-20P
20 Pair Kit			Z9981

**SPECIAL ORDERS
AVAILABLE—
Small Quantities
to Large Volume**



1/4" Tight Tolerance Parallels



Measuring Tool,
Gaging & Fixturing
Accessories



Matched Pairs

1/4" Parallel Pairs.

Precision ground in matched pairs, on two sides.

Hardened Steel, 6" Length X 1/4" Thick.

Tolerances:

Height +/- .001" from nominal

Parallelism over entire Length +/- .0001"

Total matched size tolerance in pair +/- .0001"

Individual Pairs of Parallels			
Height	Length	Thickness	Order Number
3/8"	6"	1/4"	Z9983-06
7/16	6	1/4	Z9983-07
1/2	6	1/4	Z9983-08
9/16	6	1/4	Z9983-09
5/8	6	1/4	Z9983-10
11/16	6	1/4	Z9983-11
3/4	6	1/4	Z9983-12
13/16	6	1/4	Z9983-13
7/8	6	1/4	Z9983-14
15/16	6	1/4	Z9983-15
1	6	1/4	Z9983-16
1-1/16	6	1/4	Z9983-18
1-1/8	6	1/4	Z9983-20
1-3/16	6	1/4	Z9983-22
1-1/4	6	1/4	Z9983-24
1-5/16	6	1/4	Z9983-26
1-3/8	6	1/4	Z9983-28
1-7/16	6	1/4	Z9983-30
1-1/2	6	1/4	Z9983-32
1-9/16	6	1/4	Z9983-34
1-5/8	6	1/4	Z9983-36
1-11/16	6	1/4	Z9983-38
1-3/4	6	1/4	Z9983-40
1-13/16	6	1/4	Z9983-42
1-7/8	6	1/4	Z9983-44
1-15/16	6	1/4	Z9983-46
2	6	1/4	Z9983-48

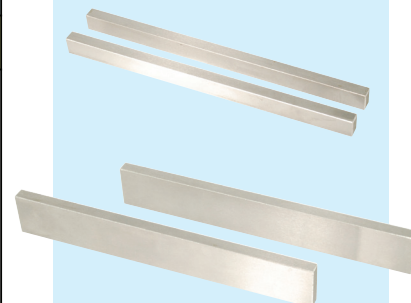

Parallel Sets in Custom Fitted Cases

1/4" Parallel Sets.

Precision ground in matched pairs, on two sides.

Hardened Steel, 6" Length X 1/4" Thick.

Wooden cases are manufactured in the USA to conform to these large Sets.

Foam inserts are molded to hold and protect each Parallel pair.

Tolerances:

Height +/- .001" from nominal

Parallelism over entire Length +/- .0001"

Total matched size tolerance in pair +/- .0001"



Sets in Custom Fitted Cases	
Description	Order Number
9 Pair Set — 3/8" thru 7/8" 3/8", 7/16", 1/2", 9/16", 5/8", 11/16", 3/4", 13/16, 7/8"	Z9983-SET1
9 Pair Set - 15/16" thru 1-7/16" 15/16", 1", 1-1/16", 1-1/8", 1-3/16", 1-1/4", 1-5/16", 1-3/8", 1-7/16"	Z9983-SET2
9 Pair Set — 1-1/2" thru 2" 1-1/2", 1-9/16", 1-5/8", 1-11/16", 1-3/4", 1-13/16", 1-7/8", 1-15/16", 2"	Z9983-SET3
22 Pair Set - 1/2" thru 1-13/16" 1/2", 9/16", 5/8", 11/16", 3/4", 13/16", 7/8", 15/16", 1", 1-1/16", 1-1/8", 1-3/16", 1-1/4", 1-5/16", 1-3/8", 1-7/16", 1-1/2", 1-9/16", 1-5/8", 1-11/16", 1-3/4", 1-13/16"	Z9983-SET4



Accurate
Manufactured
Products
Group

Phone: 317-472-9000 • FAX: 317-472-9010 • email: sales@ampg.com • www.ampg.com



H53